

P. B. & W. R. R. DELAWARE DIV.
 D. M. & V. R. R.
 PROPERTY OF THE DELAWARE MARYLAND & VIRGINIA RAILROAD
 COMPANY, TITLE TO WHICH IT IS PROPOSED TO HAVE CONFIRMED
 BY THE COMMISSIONERS OF LEWES AND DELAWARE LEGISLATURE
 FEB 20 1915 H.F.P. SCALE 1" = 200'
 No 3808A114

DEED BOOK No. 196 PAGE 22.

"EXHIBIT A"

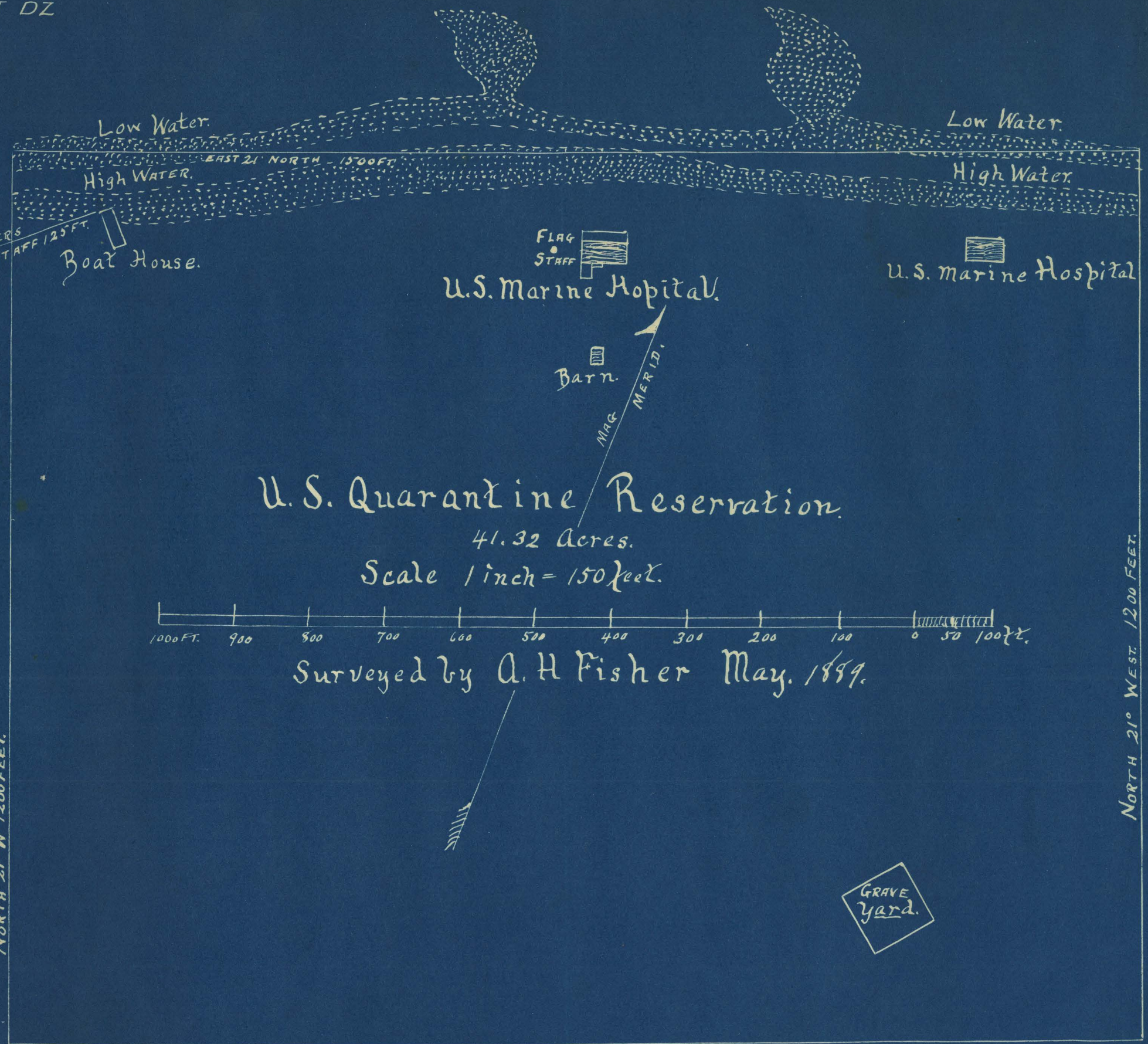

DEED Book No. 126 PAGE 367
1889

NORTH 21° W 1200 FEET

NORTH 21° WEST 1200 FEET

Surveyed by A. H. Fisher May. 1889.

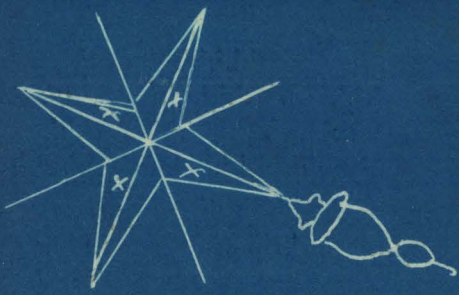

DATED: JANUARY 5, 1764

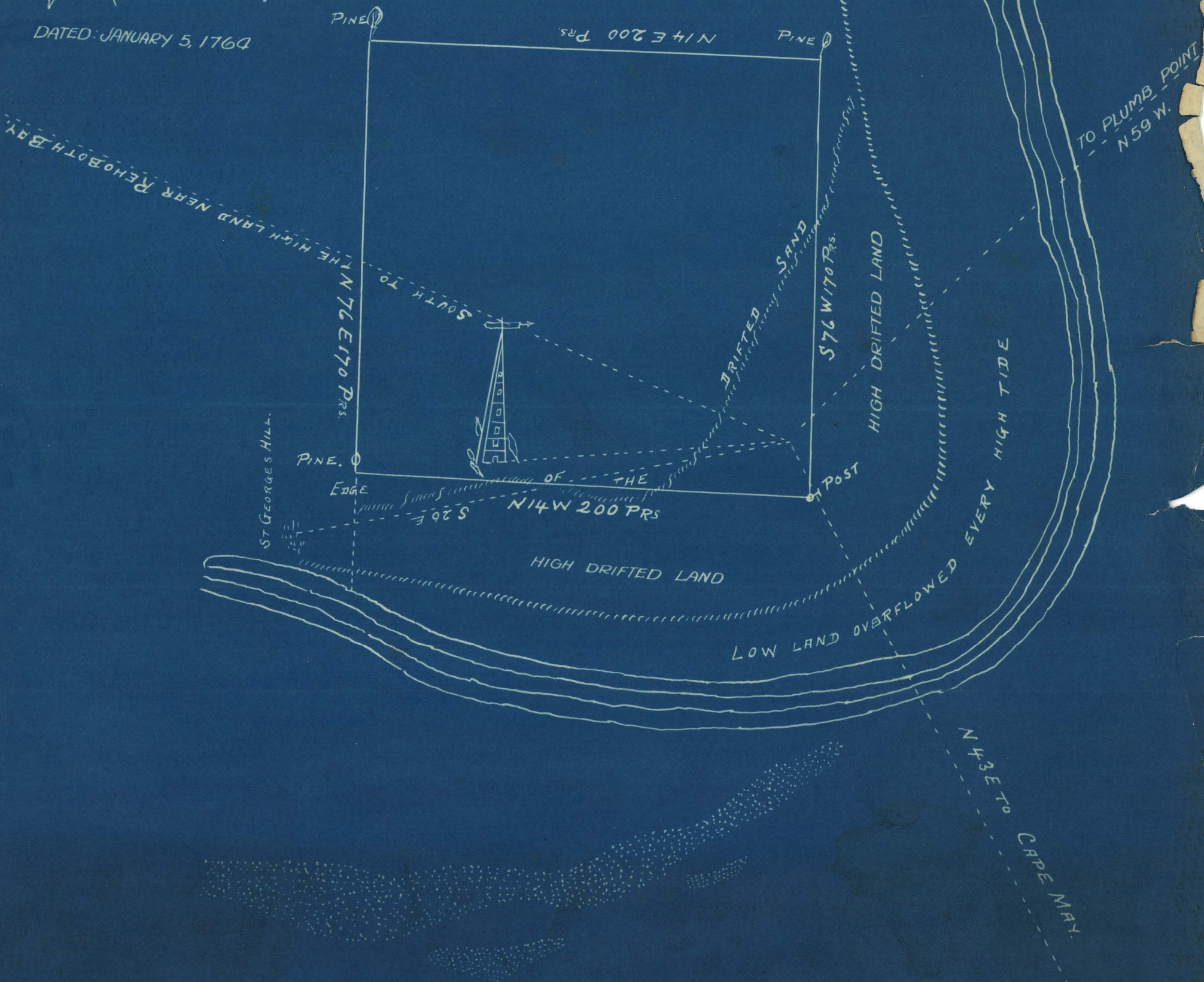

U. S. COAST AND GEODETIC SURVEY

J. E. HILGARD, Superintendent

CAPE HENLOPEN AND VICINITY
DELAWARE

Surveyed by party of W. I. VINAL, Subassistant

Sept. Oct. and Nov. 1882

Scale $20\frac{1}{000}$

Register N° 1503

*Inked by E.H.Fowler
in Drawing Division Apr. 1883*

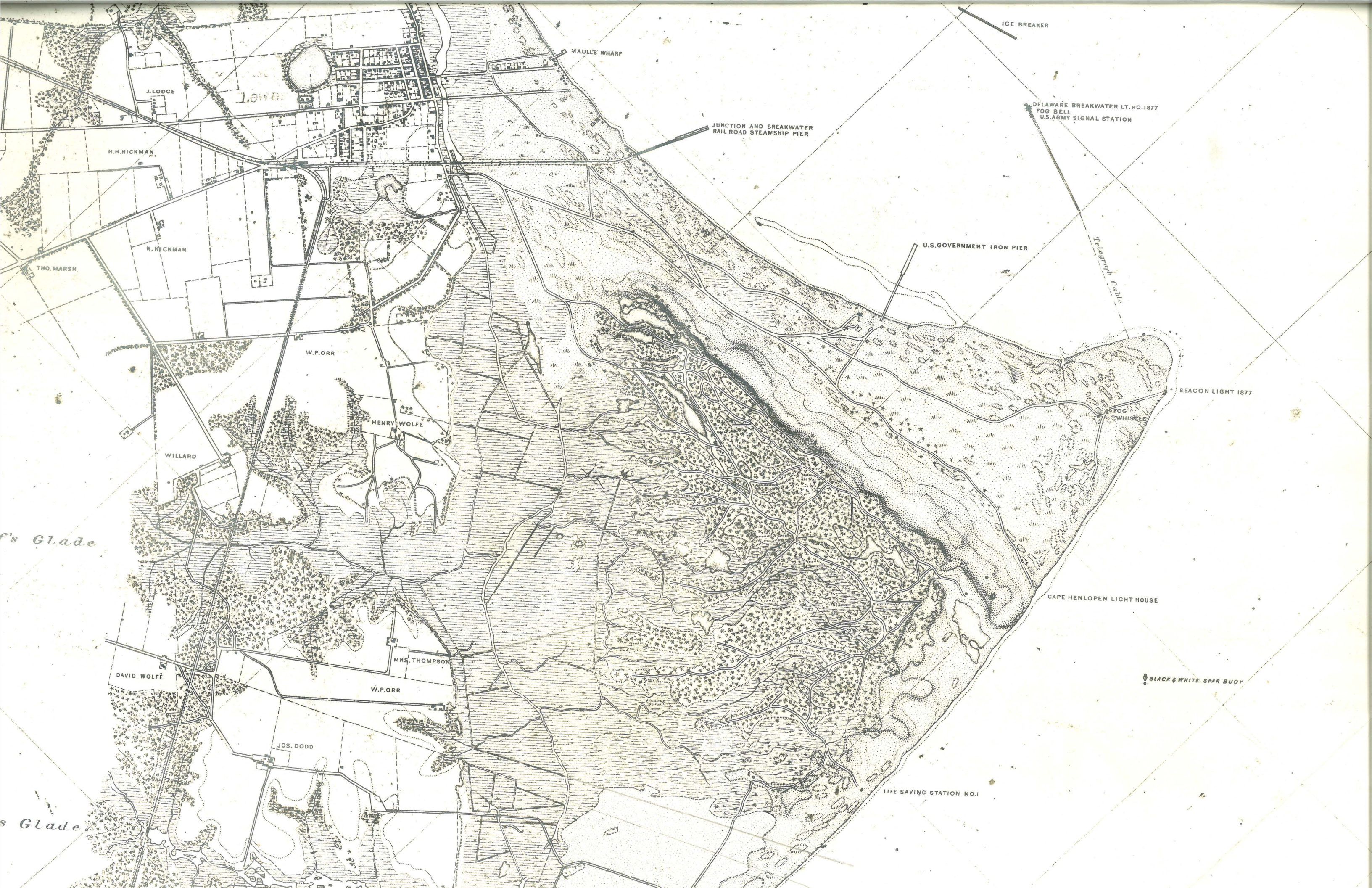

ICE BREAKER

MAULL'S WHARF

J. LODGE

DELAWARE BREAKWATER LT. NO. 1877
FOG BELL
U.S. ARMY SIGNAL STATION

JUNCTION AND BREAKWATER
RAIL ROAD STEAMSHIP PIER

H.H. HICKMAN

U.S. GOVERNMENT IRON PIER

N. HICKMAN

THO. MARSH

Telegraph Cable

W.P. ORR

BEACON LIGHT 1877

HENRY WOLFE

FOG WHISTLE

WILLARD

f's Glade

CAPE HENLOPEN LIGHT HOUSE

MRS. THOMPSON

BLACK & WHITE SPAR BUOY

DAVID WOLFÉ

W.P. ORR

LIFE SAVING STATION NO. 1

JOS. DODD

s Glade