

# KNOW all MEN by

these PRESENTS, that we *Hannah Robinson, Samuel Gregg & John Gregg* all of the

and county of New-Castle are held and firmly bound unto the Delaware State in the Sum of *Three hundred pounds* - current Money of the

said State; unto which Payment well and truly to be made unto the said State, We do bind ourselves, our Heirs, Executors and Administrators, firmly by these presents. Sealed with our Seals, and dated at New-Castle in New-Castle County aforesaid, this *fifteenth* Day of *March* in the Year of our Lord, One Thousand Seven Hundred and *ninety*.

## THE Condition of this Obligation is

such, That if the above bounden

*Hannah Robinson,*

*Widow and single*

Administrat<sup>r</sup> of all and singular the Goods and Chattels, Rights and Credits of *Charles Robinson late of Brandywine Township*

deceased, do make, or cause to be made, a true and perfect Inventory of all and singular the said Goods and Chattels, Rights and Credits, of the said deceased, which have or shall come to the Hands, Possession or Knowledge of the said *Hannah Robinson* or unto the Hands or Possession of any person or persons, for *her*

and the same so made do exhibit, or cause to be exhibited, unto the Register's Office of the county of New-Castle aforesaid, at or before the *fifteenth* day of *September* next ensuing the date hereof, and the same Goods and Chattels, Rights and Credits, of the said deceased, at the time of *his* death; or which at any time after shall come to the Hands or Possession of the aforesaid

*Hannah Robinson* or into the Hands or the Possession of any other person or persons, for *her* do well and truly administer according to Law; and further do make, or cause to be made, a true and just Account of *her* Administration, at or before the

*fifteenth* day of *March* which shall fall in the Year of our Lord one thousand seven hundred and *ninety one* - and all the Rest and Residue of the said Goods and Chattels, Rights and Credits, which shall be found remaining upon the said Administrator's Account, the same being first examined and allowed of by the Orphans Court of New-Castle County aforesaid, shall deliver and pay unto such person or persons respectively, as the said Orphans Court, by their Decree or Sentence, shall limit and appoint. And if it shall hereafter appear, that any last Will and Testament was made by the Deceased, and the Executor or Executors therein named do exhibit the same in the Register's Office, making request to have it allowed and approved accordingly; if the said *Hannah Robinson*

within bounden, being thereunto required, do surrender and deliver up the said Letters of Administration (Approbation of such Testament being first ~~had~~ made in the Register's Office) then this Obligation to be void, and of none effect, or else remain in full Force and Virtue.

Signed, Sealed and Delivered in the presence of

*Samuel Gregg*  
*John Gregg*  
*Char. Cotton*

*Hannah Robinson*  
*Samuel Gregg*  
*John Gregg*

address

Hammann = 4574

probate

Charles  
R50

Copies for reference only from the original  
in the Custody of the Delaware Public  
Archives, Hall of Records, Dover, Delaware  
19901. Permission for reproduction must  
be obtained.

Volume \_\_\_\_\_ Page \_\_\_\_\_





Newcastle County for &c. I knowledged &c. Open Court of Common Pleas hold at Newcastle for the County of Newcastle at an Adjournment  
in the November Term A. D. 1792 on the 16<sup>th</sup> of January A. D. 1793. In Testimony whereof I have hereunto  
set my hand and seal of the said Court. ————— J. M. Beckwith, C. J.

See

entry for

Return in the Rolls Office of the said County of Newcastle in Book III Vol 2. Fol 199<sup>re</sup>  
Open Court of the said Court the thirtieth day of March A. D. 1793.

Hannah Robinson  
per J. M. Beckwith

Recording Secy



be obtained.

Volume \_\_\_\_\_ Page \_\_\_\_\_

RS #50

GRANTEE.		GRANTOR.	BOOK.	VOL.	PAGE.	YEAR.
Rühle	Frederick	Henry Gibbe wife	P	8	217	1867
Reid	Frances B.	James Morrow wife	"	"	282	1868
	— + Elizabeth D.	—				
Reidel	Frederick	Andrew Dettling wuf.	H	9	222	1866
Roudnitsky	Frederick	Thos L. Cochran et al.	"	"	484	1871
Reidel	Frederick	James F. Wilson	I	"	180	"
Rumford	Francis E.	John Logus.	X	"	492	1873

Rehoba		Grant of Land so called	York Records	226	1675
Rowles	Grafton	Survey of it.	A	1	91 1682
Rappin	Gabriel et al.	accounts of. settled	"	"	150 1685
Robinson	George et al.	Arnoldus D'Logrange	"	"	180 1687
Ross	George et al.	John Earl	G	"	96 1722
* Robinson	George	Stephen Hollingworth	H	"	53 1726
Ross	George Revd	John Potts	"	"	159 1727
	same.	Gertrude W. <sup>m</sup> Gezell.	I	"	409 1730
Ret ..	George	Richard Grafton wife	K	"	333 1734
Robinson	George	Jasper Walraven wife	M	"	124 1738
	same.	Gilbert Walraven	Q	"	472 1751



GRANTEE.		GRANTOR.	BOOK.	VOL.	PAGE.	YEAR.
Read	George	Thomas Dunn	S	1	171	1756
Robinson	George	Nathan Scothorn	"	"	464	1758
	same.	Jeremiah Wollaston & wife	"	"	528	1757
	same.	Joshua Gregg	T	"	162	1759
Read	George	apptd Atty. General	U	"	350	1763
Rothwell	Gertrude	Cornelius Carty & wife	"	"	531	1762
Read	George	Henry V <sup>m</sup> Beber & wife	W	"	10	1763
	same.	apptd to administer Oath	"	"	338	1764
Robinson	George	Andrew Justis & wife	"	"	428	"
Read	George	Peter Hyatt	X	"	185	1765
Reynolds	George	William Clark	"	"	430	1766
Read	George	John Thompson et al.	Y	"	328	1768
	same.	George Morro & wife	"	"	359	"
	same.	John Finney & wife	"	"	465	"
	same.	Thomas Duff shiff	"	"	469	"
	same.	Robert Bryan et al.	"	"	514	"
	same.	et al. Benjamin V <sup>m</sup> Gezell & wife	Z	"	48	1769
Robinson	George Junr	George Stonemety et al.	"	"	631	"
Read	George	William Bedford	B	2	252	1768
Reynolds	George	Ebenzer Howell & wife	"	"	339	1774
Read	George	Peter Hyatt & wife	"	"	364	1775
	same.	John Stoofs	"	"	382	1771
Robinson	George Junr	John Sander & wife	"	"	629	1769
Reynolds	George	Ebenzer Howell & wife	D	"	335	1774
Read	George et al.	Thomas Gilpin	"	"	470	1782
	same.	John Vangezell	F	"	187	1779
	same	David Finney & wife	"	"	204	1784
	same	Thomas Morton	"	"	207	1782
	same.	Mary Van Beber et al.	"	"	208	1780
	same.	James Riddle & wife	"	"	429	1786
	same.	et al. Thos Hollingsworth	H	"	301	1789
	same.	Isaac Hollingsworth	"	"	302	"
	same.	Amer Hollingsworth	"	"	303	"
Read	George Junr et al.	Danl Chas Heath	I	"	98	1790
	same.	Thomas Kean shiff	"	"	119	"
Read	George	John Vangezell	"	"	306	1789
	same.	Leantwell Jones	K	"	61	1791

Me.

GRANTEE.		GRANTOR.	BOOK.	VOL.	PAGE.	YEAR.
	Read George	Peter Heyatt & wife	M	2	207	1792
Me.	same.	John Heyatt & wife	"	"	246	"
	same.	State of Delaware	"	"	346	1793
Me.	same.	John Bond & wife	"	"	489	"
	Read George Jr.	Andrew Miller & wife	N	"	294	1795
	Russell George	David Kivim et. al.	P	"	13	1796
	Read Geo. Junr.	Peter Parker	"	"	368	1789
	Redd George	Josh Hamilton & wife	"	"	443	1752
	Righter George	Chas Robinson & wife	Q	"	125	1786
Me.	Read George	Jas Caldwell & wife.	R	"	10	1797
	same.	Leantull Jones	"	"	19	"
	Read George Junr.	William Aull & wife	"	"	152	"
	same.	Wm Armstrong et. al.	"	"	157	"
	Read George et. al.	State of Delaware.	"	"	303	"
	same.	John Patten & wife	"	"	352	1798
	Read Jr. George et. al.	Survey of land for	"	"	426	1798
	Read George	Obadiah Sergeant	Y	"	42	1802
	same.	Maurice Rogers	A	3	273	"
	same.	Vincent Gilpin & wife	"	"	519	1804
	same.	Jesse Harry & wife	C	"	459	1803
	Russell George et. al.	John Paton et. al.	D	"	379	1791
	Rhodes George	Elizabeth Barclay (man	E	"	324	1807
	Russell George et. al.	Robert Wallace	"	"	62	1805
	Russell George	State of Delaware.	F	"	19	1807
	Rowlin George	Saml. Brunley (man	G	"	492	1809
	Russell George	E & L. Armstrong	H	"	282	"
	same.	Mary W. Donnel	"	"	288	1803
	same.	John Davis & wife	"	"	290	1799
	Read George	John Enos & wife	I	"	17	1810
	same.	Latimers & Gaddes	"	"	47	1808
	same.	James Sharples	S	"	102	1810
	Russell George	Chandler Price & wife	U	"	232	1811
	Read George	John Moody Shiff	X	"	273	1820
	Ricketts George	Mrs R. Piers & wife	Z	"	158	1822
	Read George	Robert Eakin & wife	"	"	500	1823
	same.	Rachel Eakin	"	"	505	"
	Russell George	Eleanor Ireland et. al.	"	"	504	1821



GRANTEE.		GRANTOR.	BOOK.	VOL.	PAGE.	YEAR.
Robert his	Choyce	Survey of	York Records	95	1681	
Rumsey	Charles et. al.	Edmond Andros Esq.	"	"	141	167
same.	"	same.	A	1	14	1676
same.	"	John Watkins	"	"	126	1684
same.	et. al.	Paul Poulson	B	"	92	1695
* Robinson	Charles	Francis Land	K	"	359	1735
same.	"	Thomas Noxon wife	L	"	221	1737
same.	"	David Demarest et. al.	M	"	68	"
Rhea	Christopher	John Stephenson wife	X	"	594	1766
* Robinson	Charles	Leulof Peterson wife	B	2	46	"
same.	"	William Grubb wife	"	"	112	1770
same.	"	Emanuel Grubb wife	"	"	154	1774
same.	"	Jessima Robinson	P	"	238	1785
Rebencamp	Charles	David J. Finney wife	X	"	291	1802
Rodney	Caesar A.	Mrs Neilson	"	"	321	"
Rodney	Cuff	Thomas Duff (man)	E	3	90	1806
Rodney	Caesar A.	Saml S. Voorhees wife	K	"	150	1810
same.	et. al.	Suzanna Israel et. al.	M	"	613	1813
Rhoda &	Child	Kensley Johns (man)	N	"	511	"
Ridgely	Charles G.	Augustus M. Schee wife	U	4	356	1834
* Robinson	Charles et. al.	Agreement between	V	"	482	1838
Mc. Robinson	Catharine	Henry Gibbons wife	Z	"	122	1837

articles  
agreements

	GRANTEE.	GRANTOR.	BOOK.	VOL.	PAGE.	YEAR.
	* Robinson Charles	Hannah Grubb	A	5	43	1837
	Rodney Caesar A.	Benjamin Chandler	"	"	171	1814
	* Robinson Charles	Francis Ennis wife	C	"	501	1839
No.	Rogers Charles H.	Alexander Stephens	D	"	388	1840
	Reeves Clement	Jacob Ridgway	K	"	317	1842
	Rody Charles	Eldad Love wife	M	"	154	1844
	Ryder Charles et al.	Henry White	T	"	176	1847
	Reybold Clayton B. et al.	George Maxwell wif. et al.	U	"	478	"
	same.	same.	"	"	480	"
	Rumford Caroline et al.	Thomas Rumford	W	"	197	1845
	Reybold Clayton B.	Philip Reybold wife	X	"	78	1847
	Robinson Charity	George Heanly wife	Y	"	385	1848
	Rupp Constantine	Mrs Edwards wife	A	6	363	1849
	Reybold Clayton B.	Anthony Reybold wife	K	"	270	1850
	Roberts Curtis	David C. Wilson	T	"	205	1855
	Reybold Clayton B.	David Martin wife	"	"	371	1851
	Roy Charles	Jonathan Wiley wife	W	"	310	1856
	Rudolph Charles F.	Aaron Conrad	Z	"	365	1857
	same.	Margery Tatnall	D	7	443	1858
	same.	The Trustees of Sarah T. Febiger.	G	"	84	1859
articles of agreement.	Ryne Charles	Hugh Mc Govern	N	"	158	1860
	Rudman Charles E.	Elijah Hollingsworth Trustee et al.	P	"	238	1861
	Rudolph Charles F.	Harlan & Hollingsworth	A	8	192	1865
	Robinson Charles	Thaddens Richardson wif.	C	"	267	"
	Reynolds Charles	Joshua T. Heald wif. et al.	F	"	476	1866
	Rudolph Charles F.	Joseph Roof wife	G	"	205	"
	Robinson Charles H.	John B. Lewis wife	K	"	253	1867
	Reynolds Charles	James Conley wife	L	"	333	"
	Rodney Caesar A.	Dr R. R. Porter wife	M	"	147	"
	Rudolph Charles F.	Washington Jones wif. et al.	P	"	304	1868
	Robb Charles S.	Samuel Harlan Jr.	R	"	152	"
	Rodney Caesar A.	Peter N. Brennan et al.	U	"	310	"
	Rudolph Charles F. et al. Trustees.	William E. Colton wif.	"	"	407	"
	Reeves Clement	John Reynolds Executors	X	"	377	1869
	Rodney Caesar A.	Robert R. Porter	"	"	442	1869
	Ryder Cecelia et al.	Michael Hession	Y	"	331	"



GRANTOR.	GRANTOR.	BOOK.	VOL.	PAGE.	YEAR.	GRA.
Cross Keys, Grant of land so called	York Records	116			167	Blackburn
Poultner Little Grant of land so called	"	"	35		'61	Rush
Bambury Grant of land so called	"	"	140		"	Rowman
Barnock Grant of land so called	"	"	221		'65	Radlow
Brown, Godfrey Samuel Means	S	1	50		1736	Roger
Bryan, Genl et al, Charles McEus wife	U	"	20		'72	Russell
Brown, George et al, John Brown	H	"	21		"	Smyth
Beneville, Genl et al, William Gushell wife	B	2	26		'71	Stuart
* Bedford, Gunning John Thompson	D	"	75		'74	Taylor
* Bedford, Gunning Jr, State of Delaware	E	"	353		'82	Taylor
* Bedford, Gunning et al	"	"	388		'82	Taylor
* Same	"	"	364		1781	Taylor
Booth, George James Booth	For L	"	169		1790	Taylor
* Bedford, Gunning	"	"	177		1790	Taylor
* * * Same	"	"	315	<del>358</del>	1788	Taylor
* * * Same et al	"	"	<del>315</del>	317	1789	Taylor
Bedford, Gunning	NA	"	98		1795	Taylor
Same	"	"				Taylor
Rush, Genl et al Thomas Kean	"	"	20		'77	Taylor
* Bedford, Gunning Co Korea Surge	N	"	477		1792	Taylor
Blackford Can wife William Wilson	I	"	82		'70	Taylor
* Bedford, Gunning Survey of land to	B	"	8		'68	Taylor
Booth George	R	"	57		1771	Taylor





the said Stephen Hollingsworth and Anne his wife and their heirs and assigns forever after whom because their said land marsh and tithes were descended and came to the said Stephen and Anne his wife by and in consideration of the sum of thirty pounds current money of America to them unlawfully paid by the said George Robinson the Receipt whereof they do hereby acknowledge and thereof do acquit and discharge the said George Robinson his heirs and assigns by these presents do Grant bargain and sell Release and confirm unto the said George Robinson his heirs and assigns all the said tract or piece of Land called Newmarket containing four hundred acres situate bounded and being as aforesaid And all that tract or piece of Land Marsh or Meadow Ground or Copse or other things whatsoever situate bounded and being as above described together with all the woods Meadows Marshes Swamps Cisterns ways waters water courses Fishings Fowlings Hunting Rights Liberties Privileges and Advantages and Appurtenances whatsoever to the said Land Marsh and premises hereby granted belonging or in any wise appertaining (of all which said premises hereby granted the said George Robinson is now in actual possession by virtue of a bargain and sale to him thereof made by the said Stephen Hollingsworth and Anne his wife for the term of one year from the day next before the date hereof as by an Indenture in that behalf made Dated the day next before the date of these presents may appear) And their Reversions and Remainders unto their heirs and profits thereof And all the state Right Title and Interest of them the said Stephen Hollingsworth and Anne his wife of in and to the said Tracts of Land Marsh and premises hereby granted and every part thereof with the Appurtenances And all deeds Evidence and writings Concerning the same to have and to hold the said Tracts or Pieces of Land Marsh and premises hereby granted or manured to be and every part thereof with the Appurtenances unto the said George Robinson and his heirs to the use of the said George Robinson his heirs and assigns forever UNLESS the yearly Quitrent hereafter accruing for the same to the Lord of the Fee thereof AND the said Stephen Hollingsworth the said tract or piece of Land Marsh and premises hereby granted with the Appurtenances unto the said George Robinson his heirs and assigns against them the said Stephen Hollingsworth and Anne his wife their heirs and assigns and against all other persons whatsoever lawfully claiming or to claim by force or violence them or any of them or under any of the former owners and possessors thereof their heirs and assigns shall and will warrant and forever defend by these presents AND the said Stephen Hollingsworth for himself his heirs Executors and Administrators and for the said Anne his wife doth Covenant Promise and Grant to and with the said George Robinson his heirs and assigns by these presents That he the said Stephen Hollingsworth and Anne his wife and their heirs and all and every other person and persons whatsoever claiming or lawfully claiming any Estate Right Title or Interest of in or to the said tract or piece of Land Marsh and premises hereby granted or any part thereof shall and will at any time or times hereafter upon the reasonable request Cost and Charges in Law of the said George Robinson his heirs or assigns make do acknowledge acknowledge and suffer all and every such further and other reasonable Act and Acts Deed and Deeds Conveyances and Assurances in Law whatsoever for the further and better assuring Confirming of the said Tracts or Pieces of Land Marsh and premises hereby granted and ever for any part thereof with the appurtenances unto the said George Robinson his heirs and assigns as by him or them or by his or their Council Learned in the Law shall be Reasonably devised advised or Required and used as by these presents Constituted and appointed James Robinson and James Calton



or either of them an Attorneys to acknowledge these presents in open Court at New Castle as the Law in that behalf Directs  
In Witness whereof we have Interchangeably set our hands and seals hereunto the Day and Year above written

Sealed and Delivered

in the presence of  
William m: mottson  
his  
William Drackin  
marks



John

Acknowledged in Open Court of London Pleas held at  
New Castle in and for the County of New Castle upon Delaware the  
Seventeenth Day of August Anno Domini One thousand Seven hundred  
and twenty Six. Certified under my Hand and Seal of the County.

Recorded 7<sup>th</sup> day of December 1726.

Wm. Drackin

Stephen Polingworth Seal

James Polingworth Seal

Thomas Williams

John

Indenture

made the Sixth day of December  
in the thirtieth Year of the Reign of our Sovereign Lord George Third of Great Britain & in the Year of our Lord One  
Thousand Seven hundred and Twenty Six Between Thomas Williams of the City of New Castle upon Delaware  
Plaintiff and Sarah his wife of the one part And Thomas Janvier Senr. of the same place Defendant of the other  
part Whereas in and by a certain Indenture bearing Date the Sixth Day of August Anno Domini One thousand  
Seven hundred and Twenty Three. Made between the v. Thomas Janvier and Sarah his wife of the one part  
And the v. Thomas Williams of the other part They the v. Thomas Janvier and Sarah his wife for the consideration  
therein mentioned did Grant and convey unto the v. Thomas Williams &c. that piece or lots of Land situate lying  
and being in the Town of New Castle afores. bounded on the South East with Land Street & North East with the street that  
Leadeth to the Great Ditch North West with Mary Street and the South with other lots of Land containing in breadth  
on said Street Eighty six feet and on Mary Street one hundred fifty six feet and in length three hundred feet together with the appurtenances which  
to him the v. Thomas Williams his heirs and assigns forever as in and by the said aforesaid Indenture acknowledged in open Court of London Pleas  
held at New Castle the Twentieth Day of February Anno Domini One thousand Seven hundred and Twenty Three and recorded in the  
Office at New Castle afores. in Lib G page 200. Relation being thereto had may more fully and at large appear And  
Whereas in and by a certain other Indenture bearing Date the 11<sup>th</sup> Day of October Anno Domini One thousand Seven hundred

H 1 953

Hollingsworth to  
Harris

George  
Robinson

1726



TOP

**This Indenture** made the thirty first Day of March the Twelfth Year of the Reign of our Sovereign Lord George King over great Britain &c anno Dom 1726 Between Stephen Hollingsworth of  Cecil County in the Province of Maryland gent Son & heir of Henry Hollingsworth late of Cecil County of gent Deceased and Anne his wife of the one part and George Robin of Newark in the hundred of Brandywine in the County of Newcastle upon Delaware Yeoman of the other part. Whereas William Penn late Proprietor & Governour of the Province of Pennsylvania and three Lower Counties of Virginia West and Jersey by his Warrant under his hand and Seal Dated the Twelfth Day of March anno Dom 1682 Did Grant unto Valentine Hollingsworth the late father of the said Stephen Hollingsworth the Quantity of four Hundred Acres of Land within the manor of Richland which was accordingly Surveyed on the Twenty seventh Day of December 1683 and called Newark Beginning at a Spring Tree by a small branch of Mill Creek then by a line of marked Trees west one fourth part Southerly five hundred and sixteen perches to a corner Red oak Tree South Twenty five perches to a corner beech Tree then west one hundred and Twenty Eight perches to a white Oak then North by west Eighty two perches then East by North five hundred & Eighty five perches to the said Mill Creek then down the said Creek crossing the several Courses thereof to the place of beginning containing four hundred Acres by virtue of which warrant or Survey or by force and virtue of some other Grant or conveyance duly Executed by the said Proprietor the said Valentine Hollingsworth because lawfully Seized in his Demease as of free and common tenure and in the said four hundred Acres of Land with the appurtenances AND Whereas the said Proprietor by his Commissioners William Marchbank Robert Turner and John Goodson by Patent under the said Proprietor Seal Dated the Thirteenth Day of February 1693 Did Grant and confer unto the said Valentine Hollingsworth his Heirs and assigns a Certain Tract of Marsh situate in the County of Newcastle part of Verdes Creek marsh Beginning at a line of the Marsh laid out for Thomas John running down Delaware River sixty perches to a line dividing this from the marsh laid out for Henry Hollingsworth and running on Collidas North west to a Creek called Island Creek containing and laid out for forty Acres To hold to him the said Valentine Hollingsworth his Heirs and assigns forever To be holden of the said Proprietor and his Heirs as of the said Manor of Richland in free and common tenure as by the said Patent Relation bearing thereunto had may more fully appear AND Whereas the said Valentine Hollingsworth by his Deed Pole Dated the sixteenth Day of June anno Dom 1707 as well for the consideration of Twenty Pounds Payable by the said Henry yearly to the said Valentine during his natural Life as for other valuable considerations therein enounced Did Grant and confer to the said Henry Hollingsworth the said four hundred Acres of Land and forty Acres of marsh with their appurtenances To hold to him the said Henry Hollingsworth his Heirs and assigns forever as by the said Deed Pole duly Executed may more fully appear By virtue of which said Deed Pole or by force and virtue of some other Good conveyance or Assurance in Law duly had Executed the said Henry Hollingsworth in his life time became lawfully Seized of the said Land Marsh and Marsh in his Demease as of free and free tenure as of ass after whose decease the said Land marsh and hereditaments descended and came to the said Stephen as eldest Son & heir of him the said Henry Now This Indenture Witnesseth that the said Stephen Hollingsworth and Anne his

## LOMBARDY HALL

WILLIAM PENN GRANTED 986 ACRES ("NEW ARK") TO VALENTINE HOLLINGSWORTH  
CA 1750 ORIGINAL (NORTH) PART OF HOUSE BUILT  
1785 HOUSE AND 250 ACRES (THEN KNOWN AS "PISGAH") PURCHASED BY GUNNING  
BEDFORD, JR.  
1787-1793 SOUTH WING OF HOUSE ADDED  
JANUARY 16, 1793 DEED FROM HANNAH ROBINSON SIGNED  
1793 OCCUPIED BY GUNNING BEDFORD, JR., AND FAMILY  
JANUARY 10, 1809 5 ACRES SOLD TO WILLIAM BIRD  
1812 PROPERTY OF GUNNING BEDFORD, JR., HEIRS  
JANUARY 25, 1817 ADVERTISED "TO BE LET"  
OCTOBER 12, 1833 ADVERTISED FOR SALE  
SEPTEMBER 20, 1841 PURCHASED BY GUNNING BEDFORD HACKETT  
JUNE 14, 1847 REVERTED BACK TO HENRIETTA BEDFORD  
JANUARY 7, 1848 PURCHASED BY THOMAS P. WOLLASTON  
JUNE 30, 1853 PURCHASED BY ROBERT SMITH  
NOVEMBER 13, 1865 PURCHASED BY JAMES T. BIRD  
SEPTEMBER 25, 1886 PURCHASED BY HARRY H. JOHNSON (206 ACRES)  
FEBRUARY 29, 1886 PURCHASED BY ADALINE L. NICHOLS (20 ACRES)  
FEBRUARY 21, 1889 LOMBARDY CEMETERY FORMED  
CA 1898-1918 RESIDENCE OF MR. CHARLES JONES, CEMETERY CARETAKER  
OCTOBER 21, 1911 PURCHASED BY HARRY EMMONS AT SHERIFF'S SALE  
SEPTEMBER 11, 1927 DELAWARE TRUST COMPANY TRUSTEE FOR ESTATE OF HARRY  
EMMONS  
1933-1962 RESIDENCE OF MR. CLARENCE PURSE  
JUNE 27, 1941 PURCHASED BY LOMBARDY CEMETERY COMPANY  
SEPTEMBER 21, 1967 PURCHASED BY GRANITE MASONIC HALL COMPANY  
JUNE 15, 1968 LOMBARDY HALL FOUNDATION CHARTERED AND RECONSTRUCTION  
STARTED  
DECEMBER 5, 1972 PLACED ON NATIONAL REGISTER OF HISTORIC PLACES  
1973-1974 ATTACHED GARAGE CONVERTED TO LODGE ROOM  
JUNE 20, 1976 FLAGPOLE DEDICATED  
NATIONAL HISTORIC LANDMARK PLAQUE RECEIVED  
1976 TIMBERLANE GARDEN CLUB CONTINUED LANDSCAPING GROUNDS  
1978 CREST CENTURY CLUB STARTED FURNISHING BALLROOM  
JUNE 5, 1981 GRAND LODGE OF DELAWARE 175TH ANNIVERSARY  
DECEMBER 7, 1984 FIRST LOMBARDY HALL OPEN HOUSE  
1984-1985 PARKING LOT DEVELOPED  
DECEMBER 7, 1986 FIRST ANNUAL OPEN CHRISTMAS OPEN HOUSE  
LOMBARDY HALL FOUNDATION: CREST CENTURY CLUB  
DECEMBER 7, 1987 U. S. CONSTITUTION BICENTENNIAL OPEN HOUSE  
MARCH 1988 BASEMENT EXCAVATED FOR REFRESHMENT FACILITIES  
DECEMBER 1990 BEDFORD BEDROOM FURNISHED BY CREST CENTURY CLUB  
1990 LODGE ROOM REFURBISHED (CHAIRS, CARPET, ETC.)  
OCTOBER 9, 1993 CORINTHIAN LODGE NO. 20 & GRANITE LODGE NO. 34  
CONSOLIDATED

Listed in National Register of Historic Places, December 5, 1972; designated National Historic Landmark, December 2, 1974

Form 10-300  
(Rev. 6-72)

UNITED STATES DEPARTMENT OF THE INTERIOR  
NATIONAL PARK SERVICE

NHL N491

NATIONAL REGISTER OF HISTORIC PLACES  
INVENTORY - NOMINATION FORM

STATE	Delaware
COUNTY	New Castle
FOR NPS USE ONLY	
ENTRY DATE	

(Type all entries - complete applicable sections)

NAME OF PROPERTY

COMMON NAME: **Lombardy Hall (Gunning Bedford House)**  
AND/OR HISTORIC NAME: **Pizah (prior to 1785)**

LOCATION

STREET AND NUMBER: **Concord Pike (Route 202) north of Foulk Road (Route 261)**  
CITY OR TOWN: **Wilmington** CONGRESSIONAL DISTRICT:  
STATE: **Delaware** CODE: COUNTY: **New Castle** CODE:

CLASSIFICATION

CATEGORY (Check One)	OWNERSHIP	STATUS	ACCESSIBLE TO THE PUBLIC
<input type="checkbox"/> District <input checked="" type="checkbox"/> Building	<input type="checkbox"/> Public	<input type="checkbox"/> Occupied	<input type="checkbox"/> Yes
<input type="checkbox"/> Site <input type="checkbox"/> Structure	<input checked="" type="checkbox"/> Private	<input type="checkbox"/> In Process	<input checked="" type="checkbox"/> Restricted
<input type="checkbox"/> Object	<input type="checkbox"/> Both	<input type="checkbox"/> Being Considered	<input type="checkbox"/> Unrestricted
		<input checked="" type="checkbox"/> Preservation work in progress	<input type="checkbox"/> No

PRESENT USE (Check One or More as Appropriate)

<input type="checkbox"/> Agricultural	<input type="checkbox"/> Government	<input type="checkbox"/> Park	<input type="checkbox"/> Transportation	<input checked="" type="checkbox"/> Comments
<input type="checkbox"/> Commercial	<input type="checkbox"/> Industrial	<input type="checkbox"/> Private Residence	<input checked="" type="checkbox"/> Other (Specify)	<b>anticipated</b>
<input type="checkbox"/> Educational	<input type="checkbox"/> Military	<input type="checkbox"/> Religious	<b>NOT presently</b>	<b>use as museum</b>
<input type="checkbox"/> Entertainment	<input type="checkbox"/> Museum	<input type="checkbox"/> Scientific	<b>in use</b>	<b>and meeting hall.</b>

OWNER OF PROPERTY

OWNER'S NAME: **Granite Lodge No. 34, A.F. & A.M., Mr. T. Leslie Williams, Secretary**  
STREET AND NUMBER: **Post Office Box 7036**  
CITY OR TOWN: **Wilmington** STATE: **Delaware** CODE: **19803**

LOCATION OF LOCAL DESCRIPTION

COURTHOUSE, REGISTRY OF DEEDS, ETC.: **Office of Recorder of Deeds, New Castle County Building**  
STREET AND NUMBER: **Eleventh and King Streets**  
CITY OR TOWN: **Wilmington** STATE: **Delaware** CODE: **19801**

TITLE IN ORIGINAL SURVEY

TITLE OF SURVEY: **1. Historical Buildings and Areas, New Castle County**  
**2. Division of Historical and Cultural Affairs, State of Delaware**  
DATE OF SURVEY: **1. 6-30-67 2. 6-30-72** Federal  State  County  Local  
DEPOSITORY FOR SURVEY RECORDS: **1. New Castle County Engineering Building**  
**2. Division of Historical and Cultural Affairs**  
STREET AND NUMBER: **1. Robert Kirkwood Highway**  
**2. Hall of Records**  
CITY OR TOWN: **1. Wilmington** STATE: **Delaware 19808** CODE: **Delaware 19901**  
**2. Dover**

SEE INSTRUCTIONS

STATE  
COUNTY  
ENTRY NUMBER  
DATE  
FOR NPS USE ONLY

Theme:  
Signers of the Constitution

This Indenture made this Sixteenth day of January in the year of our Lord one thousand seven hundred & ninety three between Hannah Robinson Administratrix of all & singular the goods & chattels rights & credits which were of the estate of Charles Robinson late of Brandywine & hundred of the county of New Castle deceased, of the one part; & Gunning Bedford of Borough of Wilmington Attorney at Law of the other part; Whereas the s<sup>d</sup> Charles was in his life time seized & possessed in his demesne as of fee of & in a certain tract of land laying & being in Brandywine hundred a/c called Newwork, & the s<sup>d</sup> Charles in & by a certain article of agreement duly executed under his hand & seal bearing date the fifth day of March in the year of our Lord one thousand one thousand seven hundred & eighty five proved in open Court of Common Pleas for the county of New Castle, & recorded in the Notes office for s<sup>d</sup> county in Book M - page 98 - did covenant & agree to & with the s<sup>d</sup> Gunning, to grant bargain & sell, & by good & sufficient Deed to convey & confirm to the s<sup>d</sup> Gunning his heirs & assigns for ever all that part of the a/c tract of land called Newwork, beginning at an old corner Red oak of land which Valentine Hollingsworth formerly conveyed to his son Henry, & now standing on the northerly side of Faulkner road, being also the corner of a small lot which the s<sup>d</sup> Charles sold to George Nighter, from thence with a line of s<sup>d</sup> lot south eighty three degrees & three quarters <sup>forty one perches</sup> west to a corner stone set on the easterly side of the concord road at sixty feet wide, thence with the side of the s<sup>d</sup> road south four degrees & three quarters east thirty five perches to a corner stone to be set in the old original line, & thence with the old original line west ninety perches to an old corner white oak of the original tract now standing, from thence with another old line north by west eighty one perches & five tenths of a perch to a poplar stump standing by a small run being a corner of the land which Valentine Hollingsworth sold to George Jackson, from thence with the old line north twenty four degrees east four hundred & thirty perches to a corner stone to be set in the old line, from thence by a new line south sixteen degrees ~~dividing~~ east, dividing this from the remainder of the s<sup>d</sup> tract, one hundred & twenty three perches to another corner stone to be set in the other old line side of the original tract, thence with the same south eighty three degrees & three quarters west three hundred & three perches to the first mentioned Red oak = & place of beginning; upon the payment of the consideration money therein mentioned: And whereas it now appears that the consideration money mentioned in the s<sup>d</sup> article of agreement was fully contented satisfied & paid to the s<sup>d</sup> Charles in life time, but that the s<sup>d</sup> Charles died before any conveyance was made to the s<sup>d</sup> Gunning for the premises a/c according to the tenor & effect of the s<sup>d</sup> agreement, and whereas the Court of Common Pleas for the county of New Castle a/c upon a petition preferred by the s<sup>d</sup> Hannah Robinson Administratrix as a/c for leave to execute a Deed for the premises a/c, in discharge of the s<sup>d</sup> recorded article of agreement, did order & direct the s<sup>d</sup> Hannah administratrix as a/c, to execute & acknowledge in open Court a Deed for the conveyance of the above recited tract of land & premises according to the tenor true intent & meaning of the s<sup>d</sup> article of agreement: Now This Indenture witnesseth that the s<sup>d</sup> Hannah Robinson Administratrix as a/c, for & in consideration of the premises & the full consideration money paid as a/c & which is hereby acknowledged to have been contented & paid, & of the further sum of five shillings to her in hand paid, the receipt thereof she doth hereby acknowledge & herself therein will contented satisfied & paid, has granted & bargained & sold aliened released & confirmed & by these Presents doth grant bargain & sell aliened enfeof release & confirm unto the s<sup>d</sup> Gunning Bedford his heirs & assigns, all the s<sup>d</sup> above described tract of land now called Pisgah being part of the original tract called Newwork containing two hundred & fifty acres as the same is herein buttled & bounded more or less, Together with all the houses buildings gardens orchards woods meadows ~~waters~~ water courses rights liberties privileges hereditaments & appurtenances to the s<sup>d</sup> land belonging or in anywise appertaining, & the accursions remainders rents issues & profits thereof, & all the right title estate & interest of him the s<sup>d</sup> Charles in his life time & of her the s<sup>d</sup> Hannah since the decease of the s<sup>d</sup> Charles of in & to the s<sup>d</sup> tract of land & premises hereby granted & every parcel thereof, To have and to hold the s<sup>d</sup> tract of land & premises hereby granted or intended so to be with the appurtenances & every parcel thereof unto the s<sup>d</sup> Gunning Bedford & his heirs, to the only proper use benefit & behoof of him the s<sup>d</sup> Gunning his heirs & assigns for ever; And the s<sup>d</sup> Hannah Robinson Administratrix as a/c, the s<sup>d</sup> tract of land & premises with the appurtenances unto the s<sup>d</sup> Gunning Bedford his heirs & assigns against her the s<sup>d</sup> Hannah & the heirs of the s<sup>d</sup> Charles, & against all other persons that may lawfully claim the same by from or under them or any them ~~with~~ their heirs or assigns, & against all other persons whomsoever will, shall & will warrant & forever defend by these Presents. In testimony whereof the parties to these Presents have hereunto interchangeably set their hands & affixed their seals the day & year first above written.



This Indenture made this *Sixteenth* day of *January* in the year of our Lord one thousand seven hundred & ninety three between Hannah Robinson Administratrix of all & singular the goods & chattels rights & credits which were of the estate of Charles Robinson late of Brandywine hundred & the county of Newcastle deceased, of the one part; & Gunning Bedford of Borough of Wilmington Attorney at Law of the other part; Whereas the *sd* Charles was in his life time seized & possessed in his demesne as of fee of & in a certain tract tract of land laying & being in Brandywine hundred a/c called Newwork, & the *sd* Charles in & by a certain article of agreement duly executed under his hand & seal bearing date the fifth day of March in the year of our Lord one thousand one thousand seven hundred & eighty five proved in open Court of Common Pleas for the county of Newcastle, & recorded in the Rolls office for *sd* county in Book M - page 98 - did covenant & agree to & with the *sd* Gunning, to grant bargain & sell, & by good & sufficient Deeds to convey assure & confirm to the *sd* Gunning his heirs & assigns for ever all that part of the a/c tract of land called Newwork, Beginning at an old corner *Red oak* of land which Valentine Hollingsworth formerly conveyed to his son Henry & now standing on the northerly side of Faulkner road, being also the corner of a small lot which the *sd* Charles sold to George Nighter, from thence with a line of *sd* lot south eighty three degrees & three quarters <sup>forty one perches</sup> west to a corner stone set on the easterly side of the concord road at sixty feet wide, thence with the side of the *sd* road south four degrees & three quarters east thirty five perches to a corner stone to be set in the old original line & thence with the old original line west ninety perches to an old corner white oak of the original tract now standing, from thence with another old line north by west eighty one perches & five tenths of a perch to a poplar stump standing by a small run being a corner of the land which Valentine Hollingsworth sold to George Jackson, from thence with the old line north twenty four degrees east four hundred & thirty perches to a corner stone to be set in the old line, from thence by a new line south sixteen degrees ~~east~~ east, dividing this from the remainder of the *sd* tract, one hundred & twenty three perches to another corner stone to be set in the other old line side of the original tract, thence with the same south eighty three degrees & three quarters west three hundred & three perches to the first mentioned *Red oak* place of beginning; upon the payment of the consideration money therein mentioned: And Whereas it now appears that the consideration money mentioned in the *sd* article of agreement was fully contented satisfied & paid to the *sd* Charles in life time, but that the *sd* Charles died before any conveyance was made to the *sd* Gunning for the premises a/c according to the tenor & effect of the *sd* agreement, And Whereas the Court of Common Pleas for the county of Newcastle a/c, upon a petition preferred by the *sd* Hannah Robinson Administratrix as a/c for leave to execute a Deed for the premises a/c, in discharge of the *sd* recorded article of agreement, did order & direct the *sd* Hannah Administratrix as a/c to execute & acknowledge in open Court a Deed for the conveyance of the above recited tract of land & premises according to the tenor true intent & meaning of the *sd* article of agreement: Now This Indenture Witnesseth that the *sd* Hannah Robinson Administratrix as a/c, for & in consideration of the ~~sum~~ full consideration money paid as a/c & which is hereby acknowledged to have been contented & paid, & of the further sum of five shillings to her in hand paid, the receipt thereof she doth hereby acknowledge & herself therewith contented satisfied & paid, has granted bargain & sold aliened released & confirmed & by these Presents doth grant bargain & sell aliened enfeof release & confirm unto the *sd* Gunning Bedford his heirs & assigns, all the *sd* above described tract of land now called *Bigah* (being part of the original tract called Newwork) containing two hundred & fifty acres as the same is herin bounded & bounded more or less, Together with all the houses buildings gardens orchards woods meadows ~~waters~~ water courses rights liberties privileges hereditaments & appurtenances to the *sd* land belonging or in anywise appurtenant, & the accousions remainders rents issues & profits thereof & all the right title estate & interest of him the *sd* Charles in his life time & of her the *sd* Hannah since the decease of the *sd* Charles of in & to the *sd* tract of land & premises hereby granted & every parcel thereof, To have and to hold the *sd* tract of land & premises hereby granted or intended so to be with the appurtenances & every parcel thereof unto the *sd* Gunning Bedford & his heirs, to the only proper use benefit & behoof of him the *sd* Gunning his heirs & assigns for ever; and the *sd* Hannah Robinson Administratrix as a/c, the *sd* tract of land & premises with the appurtenances unto the *sd* Gunning Bedford his heirs & assigns against her the *sd* Hannah & the heirs of the *sd* Charles, & against all other persons that may lawfully claim the same by from or under them or any them ~~with~~ their heirs or assigns, & against all other persons whomsoever will, shall & will warrant & forever defend by these Presents. In testimony whereof the parties to these Presents have hereunto interchangeably set their hands & affixed their seals the day & year first above written.

Newcastle County, fe. Acknowledged in Open Court of Common Pleas, held at Newcastle, for the County of Newcastle, at an Adjournment of the November Term, A. D. 1792, on the 16<sup>th</sup> of January, A. D. 1793. In Testimony whereof I have hereunto set my Hand, and affixed the Seal of said Court.

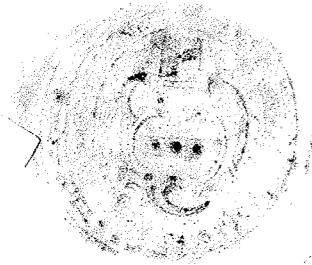

J. M. Bedford, J. C.

Newcastle County, fe.



Recorded in the Rolls Office of the said County, at Newcastle, in Book III, Vol. 2, Fol. 99 &c. Given under my Hand and the Seal of said Office, the thirtieth day of March, A. D. 1793.

J. M. Bedford, Recorder

Debit  
Hannah Robinson Donor  
to  
Gunning Bedford A

Recording &c, 7/6,

1793

1997. Permission for reproduction must  
be obtained.

Volume \_\_\_\_\_ Page \_\_\_\_\_

Hannah R to Bedford

1793 deed

98

first above written

Sealed and Delivered

in the presence of

Ellenor Love, Robert Coram,

Samuel P. Moore

Susanna Moore

Received of the above named Benjamin Burrell Seventy Pounds  
being the consideration Money above mentioned,

£70.0.0

Samuel P. Moore,

Newcastle County ss: The Execution of the within was proven  
by Robert Coram one of the Witnesses thereto in open  
Court of Common Pleas held at Newcastle for the  
County of Newcastle of the February Term A.D. 1793, In Testi-  
mony whereof I have hereunto set my Hand and affixed the  
Seal of said Court,

Jun: Bedford pro

Recorded March 15<sup>th</sup> 1793.

Articles of Agreement made and concluded this fifth day  
of March in the year of our Lord one thousand seven hundred  
and eighty five Between Charles Robinson of Brandywine  
Hundred Farmer <sup>of the one part</sup> and Gunning Bedford Att: at Law of the  
other Witnesseth that the s<sup>d</sup> Charles Robinson for and in con-  
sideration of Four Pounds & one Dollar p Acre (to be paid as  
herein after mentioned) hath granted bargained sold aliened &  
confirmed and by these presents doth grant bargain sell alien  
and confirm unto the s<sup>d</sup> Gunning Bedford his Heirs and Assigns  
for ever all that Tract or parcel of Land lying on the Concord road  
and running by two several lines Eastward the breadth of the  
Land on Concord Road and widening as you run to a line intended  
to be run at the foot of an old Field across the Plantation which  
is to be the head line of this Tract hereby sold including Two  
hundred Acres or upwards and also including all the Wood  
Land up to the said line at the foot of the old Field together with all  
the Tenements Hereditaments and Improvements thereon being  
part of a Plantation formerly belonging to Thomas Robinson  
deceased and the said Charles Robinson doth engage to warrant  
and defend the s<sup>d</sup> Tract of Land with the Appurtenances to the s<sup>d</sup>  
Gunning Bedford against the claim of the Widow of the s<sup>d</sup> Thomas  
Robinson deceased and against all other Claims whatsoever &  
to deliver up possession of the s<sup>d</sup> Plantation to the s<sup>d</sup> Gunning  
by the twenty fifth day of March next. And the s<sup>d</sup> Gunning Bedford  
doth engage to pay to the s<sup>d</sup> Charles Robinson the sum of Five  
hundred Pounds in specie on or before the first day of June next  
and the remainder of the s<sup>d</sup> sum that the s<sup>d</sup> Tract of Land may  
amount to at Four Pounds and one Dollar p Acre at three equal  
annual payments the first payment of the s<sup>d</sup> last mentioned  
sum to commence the first day of June in the year One thousand  
seven hundred and eighty six and the remainder of the s<sup>d</sup> sum  
the first day of June the year following with Interest for the s<sup>d</sup>  
last



99

last mentioned sums from the first day of June next til paid and the s<sup>d</sup> Charles is to have the privilege of cutting and taking of what grain he may now have on the Premises and also some plank that is now cut & lays on the Land, and the s<sup>d</sup> Charles is to make a Deed to the s<sup>d</sup> Gunning on the payment of the first sum mentioned and securing the remainder to be paid as a/s<sup>d</sup> in which payment is to be included what Money the s<sup>d</sup> Charles now owes to the s<sup>d</sup> Gunning on contract. And for the true and faithful performance of this agreement We the Parties bind Ourselves our Heirs Executors & Admors & every of them to the other in the penal sum of Two thousand Pounds as Witness our Hands and Seals the Day & Year above written;

Witnesses present,

Jane Wilson, Mary Parker;

Charles Robinson . . . (25)

Gunn Bedford Ju. . . (26)

Received the fifth day of March 1785 of Gunning Bedford J<sup>r</sup> the sum of Twenty Dollars in part of the consideration Money mentioned in the a/s<sup>d</sup> agreement.

Charles Robinson,

Newcastle County J<sup>s</sup>. The Execution of the foregoing was proven by

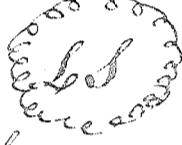
 Jane Wilson one of the Witnesses thereto in open Court of Common Pleas held at Newcastle for the County of Newcastle at an adjournment of the November Term A. D. 1792, on the 16<sup>th</sup> of January 1793. In Testimony whereof I have hereunto set my Hand and affixed the Seal of said Court.

Recorded March 29<sup>th</sup> 1793.

Gunn Bedford J<sup>r</sup>

This Indenture made this sixteenth day of January in the year of our Lord One thousand seven hundred and ninety three Between Hannah Robinson Administratrix of all and singular the Goods and Chattles Rights and Credits which were of the Estate of Charles Robinson late of Brandywine Hundred & the County of Newcastle deceased of the one part & Gunning Bedford of the Borough of Wilmington Attorney at Law of the other part Where the s<sup>d</sup> Charles was in his life time seized and possessed in his demesne as of fee of & in a certain Tract Tract of Land laying and being in Brandywine Hundred a/s<sup>d</sup> called Newwork & the s<sup>d</sup> Charles in & by a certain article of agreement duly executed under his Hand and Seal bearing date the fifth day of March in the year of our Lord One thousand seven hundred & eighty five proved in Open Court of Common Pleas for the County of Newcastle & Recorded in the Rolls Office for s<sup>d</sup> County in Book . . . page . . . did covenant and agree to and with the s<sup>d</sup> Gunning to grant bargain & sell & by good & sufficient Deed to convey assure and confirm to the s<sup>d</sup> Gunning his Heirs and Assigns forever all that part of the a/s<sup>d</sup> Tract of Land called newwork Beginning at an old corner Red Oak of Land which Valentine Hollingsworth formerly conveyed to his Son Henry & now standing on the Northerly side of Soull's Road being also the corner of a small Lot which the s<sup>d</sup> Charles sold to George Righter from

thence

M2 P 98

C. Robinson to Bedford

agreement to buy 1780 →

New Castle County Brandeis  
Hund. Tenth Draught of  
O.S. A. for Geo. Robinson  
adjudged & returned to  
William Forward

[not received]

72  
74

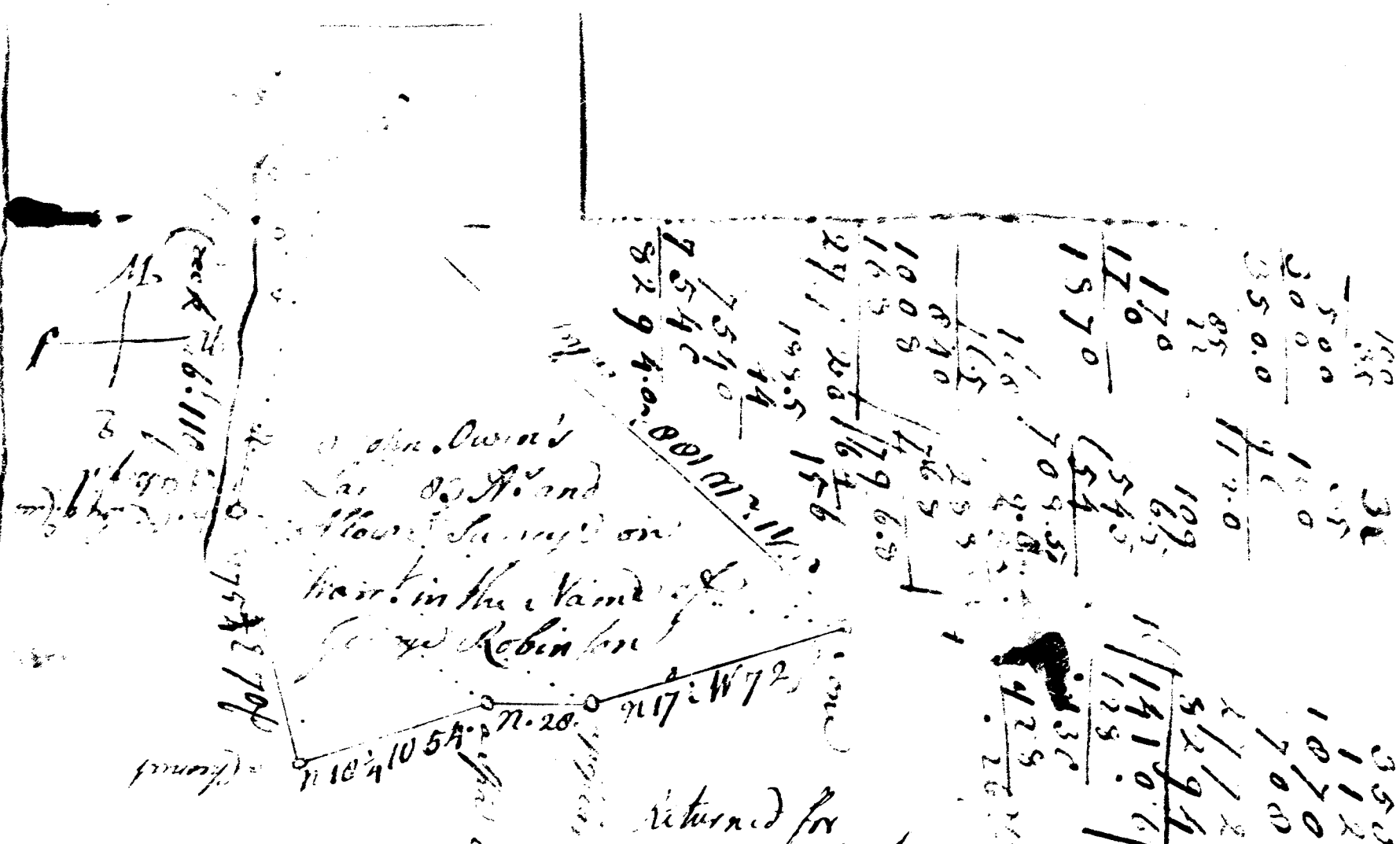

John Owen's  
 Lot 23 A. and  
 flow Survey on  
 West. in the Name of  
 George Robinson

N. 10° 45' E. 10.20  
 N. 17° W 72

Newcastle County  
 Brandon Ham

Returned for  
 Wm Forward in pursuance  
 on Order of Court 6<sup>th</sup> 1749

A Draught of a part of Land Situate in  
 the Hubbs & Co. Top. Survey & the 21<sup>st</sup> day of June 1748 for  
 George Robinson L. 23 A. & flow. against which there is a  
 caveat entered by one Gubb. Land settled many years  
 within the Manner of Reck Land as by said

By James Bratton  
 & B. James Kirby

Geo. MULLWORTH Junr

100  
 500  
 200  
 350.00  
 85  
 170  
 170  
 1570  
 154  
 709.55  
 165  
 165  
 112.0  
 109  
 65  
 1545  
 1410.60  
 123  
 3294  
 1070  
 7000  
 112  
 112  
 1070  
 7000  
 350



19901. Permission for reproduction must  
be obtained.

Volume \_\_\_\_\_ Page \_\_\_\_\_

RZ # 44

Pennsylvania and  
Colony on Delaware &c -

By the Proprietaries -

Whereas upon the Request of George Robinson of Our Manor of Rochland  
in the County of Newcastle We granted Our Warrant under Our lesser Seal bearing date  
the twenty seventh day of May in the Year of Our Lord 1734 for Resurveying the  
Tract of Land whereon the Dittels within Our said Manor first Surveyed and laid  
out to him for Two hundred Acres but within the Lines & Bounds of the Same there <sup>appears</sup>  
to be a considerable overplus which with some other Land thereunto adjoining the  
said George now requests that We would be pleased to grant him such an addition  
to the same as might increase the said Tract to the Quantity of Three hundred Acres  
for which addition the said George Robinson agrees forthwith to pay to Our Use  
fifty Spanish money of Pennsylvania and the yearly Dues of One Bushell of  
good winter Wheat for each hundred Acres, These are therefore to authorize & require  
Thee to Resurvey or cause to be Resurveyed unto the said George Robinson the said Tract  
of Two hundred Acres of Land and to make such an Addition thereunto as in the  
whole will be Three hundred Acres and Returne the same by regular Lines & Bounds  
into Our Secretarys Office in order for Confirmation Given under my hand and lesser  
Seal at Philadelphia this 15th day of Decemr Anno Dom 1735

To Very Eastburn Survey Genl

W. M.

be obtained.

Volume \_\_\_\_\_ Page \_\_\_\_\_

R' #30

warrants Robertson

George Robinson  
a Referee on part  
of the Mannor of  
Rocklands

---

<sup>p. 336</sup>  
Recorded  
&  
Examined

R1  
A<sup>n</sup> 300



Newcastle  
George Robinson 200

Ent

Recorded  
p. 337 and  
Examined

R  
A<sup>o</sup> 33

Pensilv. & Counties  
on Delaware

By the Proprietaries

At the Instance and Request of George Robinson of Our Mannor of Rocklands  
in the County of Newcastle that We would be pleased to Grant him a Resurvey of a certain  
Tract of Land situate near Skilpot Creek within the Said Mannor. first surveyed unto  
him in the Year 1689 for two hundred Acres and from that time to this has been  
held and possessed by him the Said George. We therefore do Authorize and ~~authorize~~ ~~authorize~~ ~~authorize~~  
to Resurvey or cause to be Resurveyed unto the Said George Robinson according to the  
first Lines and bounds thereof the Said Tract of Two Hundred Acres of Land & make  
exact Returne of the Same into the Secretarys Office in order for Confirmation and for  
Soe doing this shall be they sufficient Warrant given Under my hand and the  
Lessor Seal of the Province at Philadelphia this 27<sup>th</sup> day of the 3<sup>mo</sup> (May) An<sup>no</sup> Dom 1734

To Benj<sup>l</sup> Eastburn Surveyor Gen<sup>l</sup>

W<sup>m</sup> Penn

be obtained.

Volume \_\_\_\_\_ Page \_\_\_\_\_

R' # 33

George Robinson 300

in Rockland Mann?

Newcastle County

Returned into the Col. <sup>8</sup> ~~the~~  
the 2<sup>d</sup> of June 1737

Recorded in  
Page 457 Book  
of Surveys.

e. H.



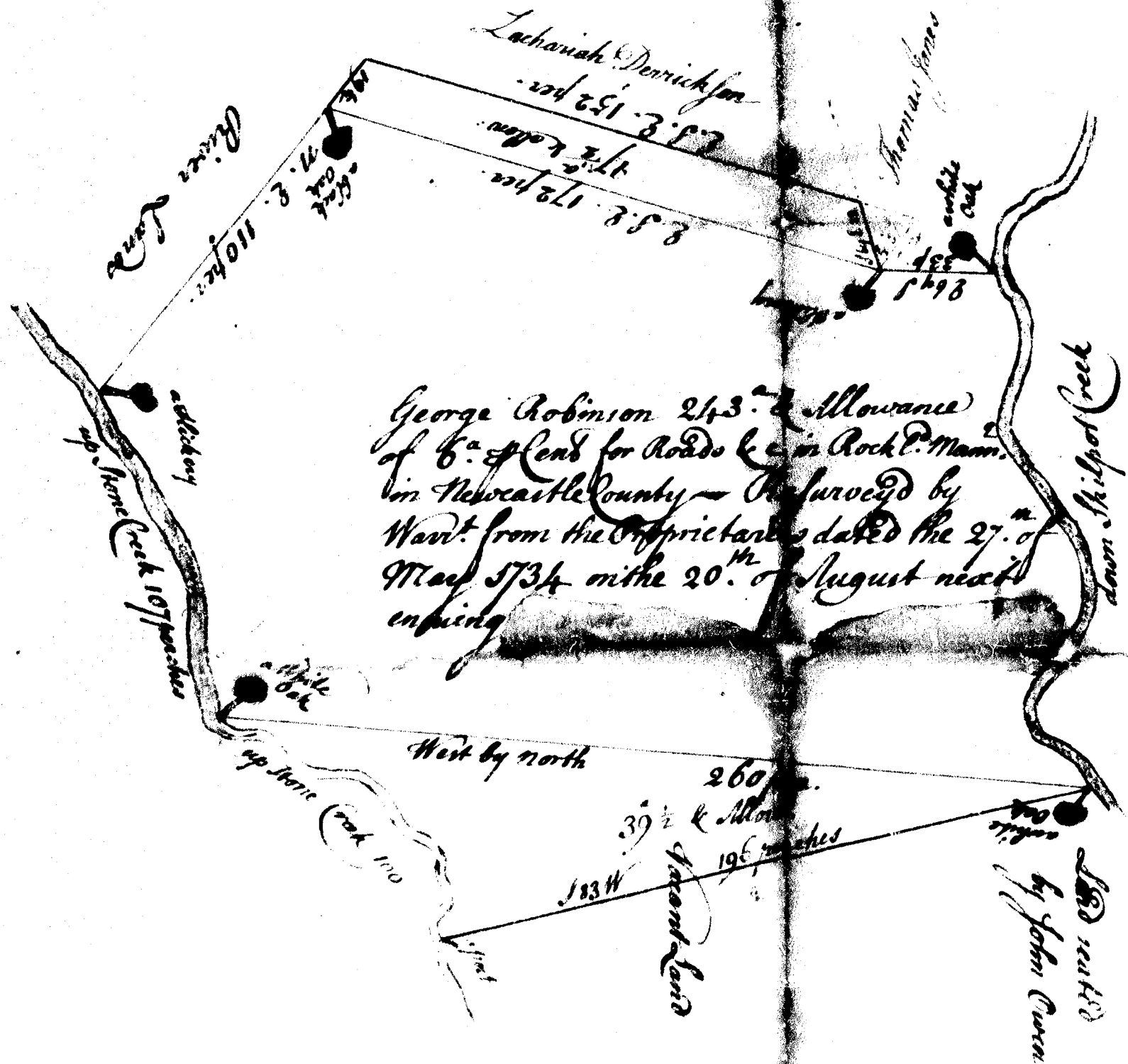

Lachariah Derrickson

252 per

172 & 100

252 per

Thomas Jones

White Oak

183 W

George Robinson 252<sup>1/2</sup> Allowance  
 of 6<sup>1/2</sup> per cent for Roads &c in Rockl. Mann.  
 in Newcastle County - Surveyed by  
 Warrant from the Proprietaries dated the 27<sup>th</sup> of  
 May 1734 on the 20<sup>th</sup> of August next  
 ending

West by north

260<sup>1/2</sup>

39 1/2 & Allow

183 W

Warrant Land

196<sup>1/2</sup> reaches

White Oak

180<sup>1/2</sup> reached  
 by John Croom

1997. Permission for reproduction must  
be obtained.

Volume \_\_\_\_\_ Page \_\_\_\_\_

R<sup>2</sup> #1



Geo: Robinson 248.  
C. N. C. County

Recorded in  
Page 258. Book  
of Surveys. —

TR  
A2



up above (from 107 acres)  
West side

vacant

subject to the above

George Robinson 243 acres & the  
allotments of the 1st Cont in Scotland  
- Mannors in Newcastle County

Reference by warrant  
from the High Court dated the 20th  
May 1794, that the High Court  
of Chancery of the said Court

Wm. Taylor

George Robinson

C. S. 172 1/2 acres  
George Robinson 20.9  
C. S. 172 1/2 acres

John Brown  
of the County of

175 Acres  
Down & Hilpot Creek

The 20.9 is a vacancy left between the  
old survey, which Geo. Robinson requests  
may be added to by 243.9

Rec<sup>d</sup> of J. T. my for

1987. Permission for reproduction must  
be obtained.

Volume \_\_\_\_\_ Page \_\_\_\_\_

R 242

George Robinson  
in the Mann<sup>r</sup> of Rocklanos <sup>39½</sup>

Returned in the 300<sup>a</sup>

Recorded in  
Page 456 Book  
of Surveys.

R<sup>r</sup>  
A. 3.

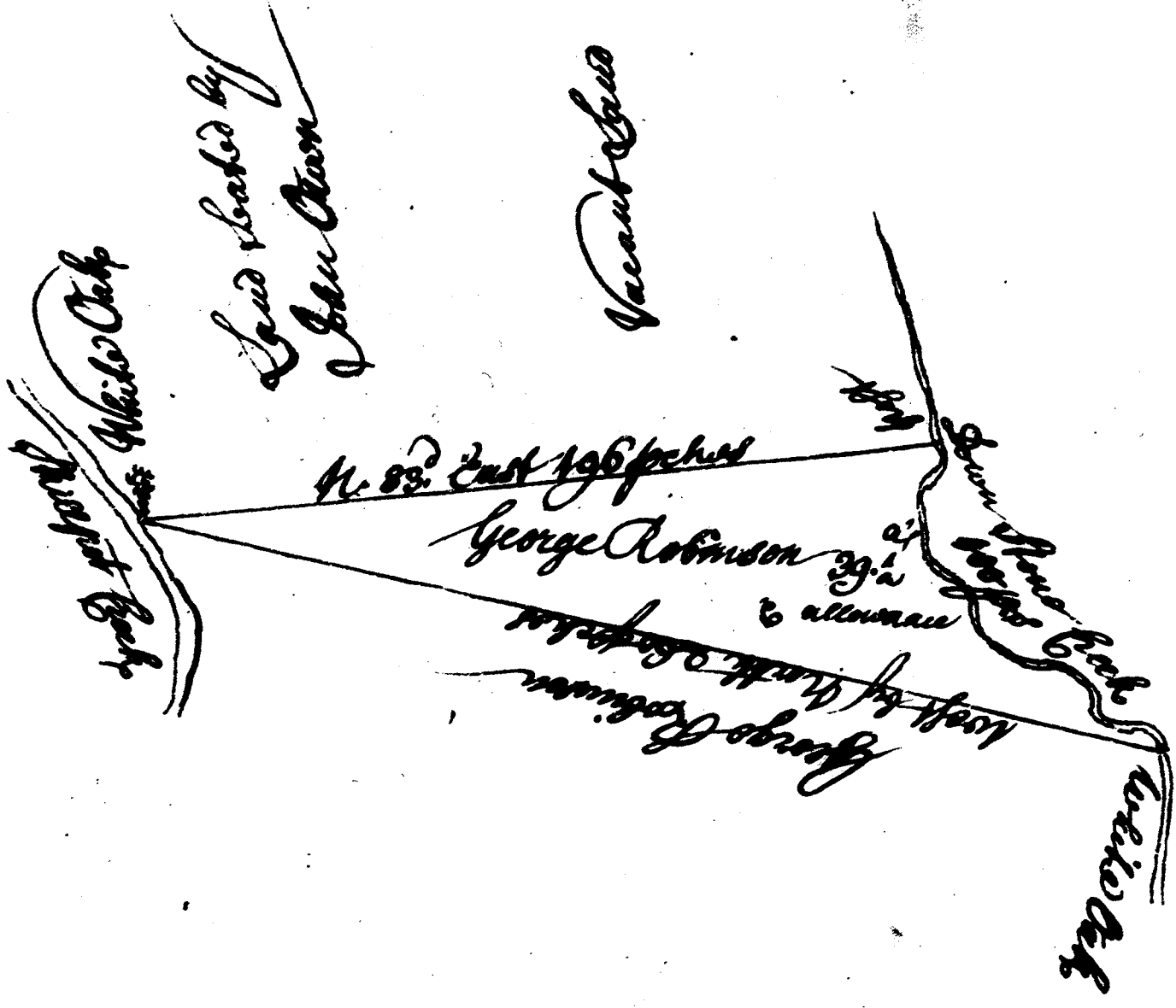

In Pursuance of a Warrant from the Proprietaries dated the 19<sup>th</sup> day of May 1725 Surveyed unto George Robinson on the 25<sup>th</sup> of July 1725 being a certain piece or parcel of land & Situation in the Manor of Rockland in New Castle County South North side of a Tract of 243 acres lately Referred to him) Beginning at a White Oak by Stone Creek being a corner of the said Tract thence West by North by of same 26 pches to another White Oak by Shickel Creek being also a corner of the said Tract thence North 83. East by Land leased by John Owen & Vacant Land 196 pches to a post by the said Stone Creek then down the same on the several courses thereof one Hundred pches to the place of Beginning containing thirty nine acres & a half with the allowance of a Road

M<sup>r</sup> Taylor



be obtained.

Volume \_\_\_\_\_ Page \_\_\_\_\_

R<sup>2</sup> # 3

George Robinson  
175  
in the Mann<sup>r</sup> of Bodleian

Returned in y<sup>e</sup> 300<sup>th</sup>

Recorded in  
Page 45809. Book  
of Surveys.

R  
A

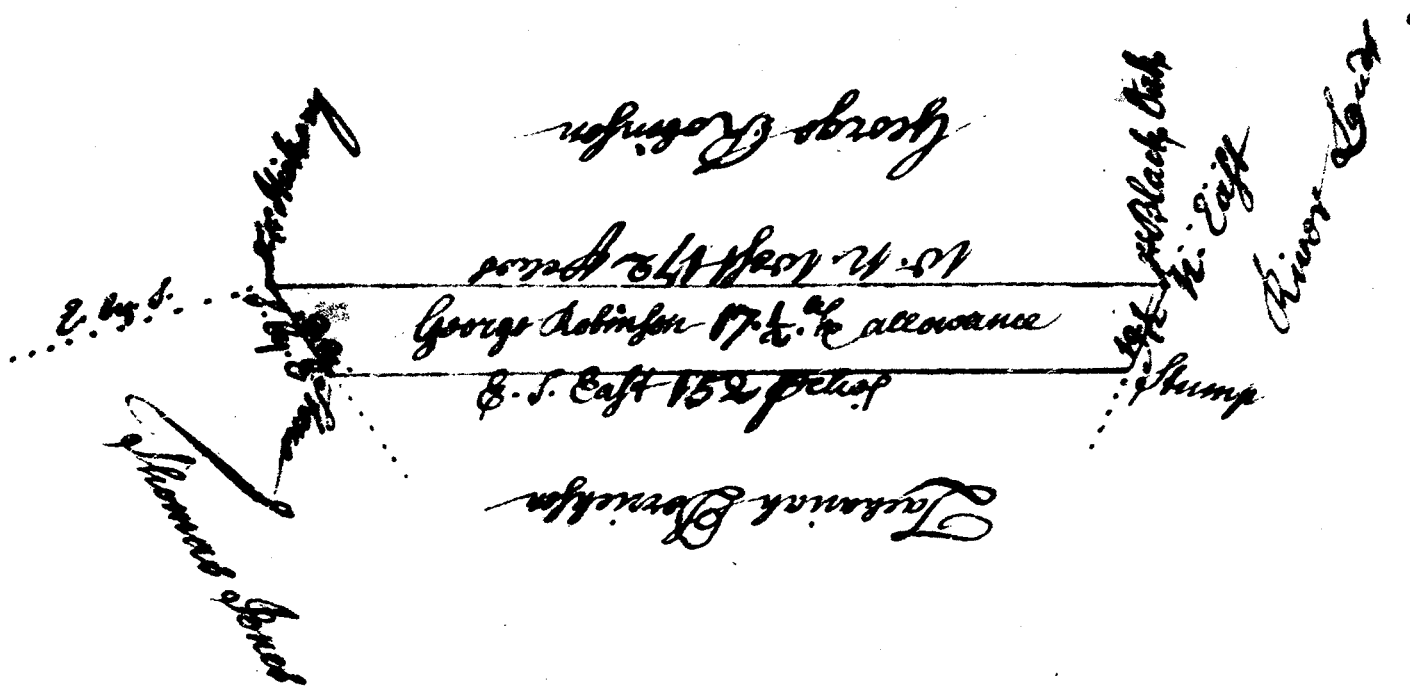

In Pursuance of a Warrant from the Proprietaries dated the 20<sup>th</sup> of July then next Enjoining a certain piece or parcel of land in the Manor of Rochland in the County of Howards (lying on the south side of a Tract of 248 acres lately referred to him) Beginning at a Hickory being a corner of the afo<sup>re</sup> Tract thence & by East by the land of Thomas Jones 22 poles to a stone thence E. & East by Zachariah Dorrickson's Land 152 poles to a Stump, thence North East by the River Land 1/2 pole & a half to a Black Oak thence West North West by the George Robinson's Land 17 1/2 poles to the place of Beginning containing about an acre & a half, with the usual allowance for Roads.

W. Taylor

1990. Permission for reproduction must  
be obtained.

Volume \_\_\_\_\_ Page \_\_\_\_\_

R2#4



New Castle Co. N	# 3
Grubb v. Robinson	" 2
	1 " 2
	" 6
	" 4
	<hr/>
	3 " 5

1748

Rockland  
Manor

[not recorded]

A<sup>2</sup>  
# 442

Joseph Grubb } Land in Rockland Manor

Geo. Robinson } John Owen and Hugh his Father has been  
in Possession of the Land near ~~or~~ 40 Years - by the  
Consent and approbation of the <sup>r</sup> John George Robinson  
obtained a Grant from the Hon<sup>ble</sup> Proprietaries ~~and~~  
~~and~~ bearing Date the 10<sup>th</sup> Day of June 1740 -  
for <sup>r</sup> Land and agreed that John Owen should  
live on <sup>r</sup> Land Rent Free during his natural Life  
and procured a Survey to be made the 21<sup>st</sup> of June  
last by George Stevenson against the Return  
of which Survey Joseph Grubb Adm<sup>r</sup> of Joseph  
Grubb Deed has entered a Covenant for the Reasons

following to say first because the <sup>r</sup> John  
is Indebted to the said ~~to~~ Joseph Grubb Deed  
in divers Sums of Money amounting to £100  
in the Whole

2<sup>d</sup> Because the <sup>r</sup> Joseph Adm<sup>r</sup> of afs<sup>r</sup> has sued one  
~~one of~~ a Bond of <sup>r</sup> Owen to <sup>r</sup> Joseph Deed  
and obtained Judgem<sup>t</sup> and has levied on the  
Improvement of <sup>r</sup> Owen and set the Sheriff of  
New Castle County on the 10<sup>th</sup> of Aug<sup>r</sup> exposed the  
Improvement to Sale in pursuance of an  
Order of the <sup>r</sup> Court

W<sup>ill</sup> ~~and~~ the same sold to the <sup>r</sup> Joseph for  
the Sum of £75<sup>..</sup>10<sup>..</sup> wherefore the <sup>r</sup> Joseph  
prays that the same may be granted to him  
& he will comply with the Office Terms

N.B. The Improvem<sup>t</sup> is worth much more  
this Hearing the 24<sup>th</sup> of Feb. 1740 by an Order  
of the Secretary before  
Geo Stevenson

Henry Grubb brother of the s<sup>r</sup> Joseph the Plff<sup>t</sup>,  
says he was present and the s<sup>r</sup> Improvement was  
sold to the s<sup>r</sup> Joseph for £1500. George was  
present himself and acknowledges that it is  
true which Henry says

The Parties will attend at the S<sup>r</sup> Office on  
Thursday Morning next

The above state of the case was taken the 25<sup>th</sup> of Feb. 1788 in  
presence of the Parties in pursuance of an Order for that purpose  
given by the s<sup>r</sup> Secretary bearing date the 10<sup>th</sup> of Jan<sup>y</sup> last  
and it is humbly submitted to the determination of the Secretary to  
which who shall have the preference privilege of

Volume \_\_\_\_\_ Page \_\_\_\_\_

R2 # 44a

John. Wolmer  
juror of the  
Land  
In the  
Castle

1674

Recorded in  
Page Book  
of Surveys

1675





19901. Permission for reproduction must  
be obtained.

Volume \_\_\_\_\_ Page \_\_\_\_\_

Survey of  
Hollingsworth's land

He 84

HR # 45

7. DESCRIPTION

CONDITION	(Check One)					
	<input type="checkbox"/> Excellent	<input type="checkbox"/> Good	<input checked="" type="checkbox"/> Fair	<input type="checkbox"/> Deteriorated	<input type="checkbox"/> Ruins	<input type="checkbox"/> Unexposed
	(Check One)			(Check One)		
	<input type="checkbox"/> Altered	<input checked="" type="checkbox"/> Unaltered		<input type="checkbox"/> Moved	<input checked="" type="checkbox"/> Original Size	

DESCRIBE THE PRESENT AND ORIGINAL (If known) PHYSICAL APPEARANCE

In 1785, Gunning Bedford, Jr., purchased a 250-acre farm named Pizgah from Charles Robinson, a great-grandson of the grantee of William Penn's "Manor of Rocklands." On this farm stood a small stone house dating from 1750 or shortly before. It consisted of four rooms, two on each floor, with a right-side entrance and a hallway connecting the front and rear doors. Behind a wall cupboard in a rear room on the ground floor there remains the lintel of an old doorway, which suggests that the interior originally lacked paneling. As for the severely plain exterior, Eberlein and Hubbard have noted that "the absence of outside architectural amenities on a presumably Georgian body is suggestive of a prevalent Quaker influence."

Bedford occupied the house in 1793, renaming it Lombardy Hall. Although he kept his town house at 606 Market Street in Wilmington (which is still extant, but drastically altered), he resided at Lombardy periodically for the remainder of his life. He effected one major change, the southern addition consisting of a ballroom downstairs and two bedrooms above, thereby creating a symmetrical five-bay facade. The Brandywine gabbro stone in the "Bedford section" was skillfully matched to the older portion, although the location of the original south wall is evident from the vertical line of mortar in both the facade and in the fieldstone north wall. The exterior dimensions of the house are 30 by 46 feet, and the entire tract now comprises about 1-1/2 acres.

Since 1968 Lombardy Hall has been owned by the Lombardy Hall Foundation, an affiliate of the Wilmington Masonic Order, whose interest in Bedford stems from his having been the first Grand Master of the Delaware Masons. So far, the exterior has been restored to much the way it looked in Bedford's time (except, of course, for the garage attached to the south side). Chimneys have been repaired and seven new flues installed. The slate roof has been replaced, as have the front door, most of the 3 over 9 windows, and the shutters. The moldings have been restored, and two non-original windows of the north wall filled in. The south exterior wall and the rear still require attention, and the interior needs a great deal of work, although the original chair rails, cornice moldings, stairs, banisters, and much of the paneling are in good condition. The windows of the "Robinson section" are recessed in 18-inch walls at right angles, while in Bedford's addition they are set in wide-angled paneled recesses. The door to the ballroom repeats this motif. In the ballroom there is also an Adam-style mantel, delicately carved and shelved at each end. The only significant interior alteration is "the addition of a bathroom off the second floor hall.

A large portico and wing with a separate entrance, added around 1820, was removed before the end of the 19th century. The garage, dating from the 1920s, is built out of stone recovered from a demolished barn

(continued)

SEE INSTRUCTIONS

UNITED STATES DEPARTMENT OF THE INTERIOR  
NATIONAL PARK SERVICE  
NATIONAL REGISTER OF HISTORIC PLACES  
INVENTORY - NOMINATION FORM

(Continuation Sheet)

STATE Delaware	
COUNTY New Castle	
FOR NPS USE ONLY	
ENTRY NUMBER	DATE

(Number all entries)

7. Description (page 1) Lombardy Hall (Gunning Bedford House)

and carriage house. The Lombardy Hall Foundation plans either to remove it entirely, or keep it as a meeting hall with the roofline rebuilt to match that of the house. Serving as consultants for the restoration are a Wilmington architectural firm and also the Delaware Archeological Society. The organization which is financing it is deeply concerned with authenticity and plans to spend some \$46,000 prior to completion in 1976.

**SIGNIFICANCE**

PERIOD (Check One or More as Appropriate)

Pre-Columbian      16th Century      18th Century      20th Century  
 15th Century      17th Century      19th Century

**SPECIFIC DATA (If Applicable and Known)**

AREAS OF SIGNIFICANCE (Check One or More as Appropriate)

<input type="checkbox"/> Aboriginal	<input type="checkbox"/> Education	<input checked="" type="checkbox"/> Political	<input type="checkbox"/> Urban Planning
<input type="checkbox"/> Prehistoric	<input type="checkbox"/> Engineering	<input type="checkbox"/> Religion/Philosophy	<input type="checkbox"/> Other (Specify)
<input type="checkbox"/> Historic	<input type="checkbox"/> Industry		_____
<input type="checkbox"/> Agriculture	<input type="checkbox"/> Invention	<input type="checkbox"/> Science	_____
<input type="checkbox"/> Architecture	<input type="checkbox"/> Landscape	<input type="checkbox"/> Sculpture	_____
<input type="checkbox"/> Art	<input type="checkbox"/> Architecture	<input type="checkbox"/> Social/Humanitarian	_____
<input type="checkbox"/> Commerce	<input type="checkbox"/> Literature	<input type="checkbox"/> Theater	_____
<input type="checkbox"/> Communications	<input type="checkbox"/> Military	<input type="checkbox"/> Transportation	_____
<input type="checkbox"/> Conservation	<input type="checkbox"/> Music		_____

**STATEMENT OF SIGNIFICANCE...**

SEE INSTRUCTIONS

Gunning Bedford, Jr., was a leading figure in Delaware politics during the 1780s, filling several State posts, then serving as a delegate to the Continental Congress, the Annapolis Convention, and the Constitutional Convention of 1787. At Philadelphia he attained national prominence, largely as the result of an oration which James Madison characterized as the "most intemperate speech uttered in the Convention." Unless the new Constitution provided adequate protection for the rights of the small States, Bedford declared, "there are foreign powers who will take us by the hand." Many of Bedford's fellow delegates were profoundly shocked that, in the words of Rufus King, he had "declared himself ready to ... court the protection of some foreign land." Nevertheless, it was the protests of small-State partisans such as Bedford which eventually led to the Convention's acceptance of a legislative structure putting all States on an equal footing in the Senate.

Bedford lived out the remainder of his life in relative obscurity as a Federal judge. During the two decades prior to his death, he frequently entertained his many illustrious friends at his country home, Lombardy Hall. Now, after years of neglect, Lombardy Hall is under restoration and the exterior appears such as it did in Bedford's time. It is anticipated that the entire project will be completed by 1976, at which time Lombardy Hall will be opened to the public as a library and museum.

Biography

The political philosophy of Gunning Bedford, Jr., stood him considerably to the left of most of the other delegates to the Philadelphia Convention of 1787, at least of the ones who actually signed the Constitution (16 of those delegated did not sign). James Madison, his one-time college roommate, noted that "Mr. Bedford was opposed to every check on the Legislative" and believed that "The Representatives of the People were the best judges of what was for their interest, and ought to be under no external controul [sic] whatever." Bedford was also determined to assert the rights of the small States, even hinting that they might have to seek foreign

(continued)



UNITED STATES DEPARTMENT OF THE INTERIOR  
NATIONAL PARK SERVICE  
NATIONAL REGISTER OF HISTORIC PLACES  
INVENTORY - NOMINATION FORM

(Continuation Sheet)

STATE	
Delaware	
COUNTY	
New Castle	
FOR NPS USE ONLY	
ENTRY NUMBER	DATE

(Number all entries)

8. Significance (page 1) Lombardy Hall (Gunning Bedford House)

protection if the Constitution permitted legislative domination by the more populous States.

This was naturally a major concern of the entire Delaware delegation. However, Bedford himself was a relative newcomer to the State, having settled there only eight years before at the age of 32. Born in Philadelphia in 1747, he graduated as class valedictorian from Nassau Hall (now Princeton University) in 1771, read law back in Philadelphia, and set up practice. In 1779 he moved to Dover, and shortly thereafter to Wilmington. During the 1780s, Bedford served successively as a member of the State Legislature and the State Council, as State Attorney General, and as a delegate to the Continental Congress, the Annapolis Convention, the Philadelphia Convention, and the Delaware Convention of Ratification.

Bedford's role at Philadelphia seems to be a matter of some disagreement. Charles Beard insists he "did not participate extensively in the debates," while Edmund K. Aldon contends he "played a considerable part" and expounded his radical views "often and with emphasis." The latter estimate seems the more viable, especially since it would have contradicted Beard's preconceptions about the Convention to have suggested that Bedford, a man of marked democratic propensities, was an influential figure there.

There is little doubt that on one occasion at least Bedford made his presence most conspicuous. Madison regarded his speech of June 30, 1787, in which he suggested that there were "Foreign Powers who will take [the small states] by the hand" if the Convention decided to apportion both branches of Congress on the basis of population, as the "most intemperate ... uttered in the Convention." Be that as it may, Bedford evidently deserves much of the credit for persuading his fellow delegates to consider and eventually to adopt the provision whereby each State was given equal representation in the Senate. Beyond that, although pietistic accounts sometimes praise Bedford for inducing Delaware to become the first State to ratify the new Constitution, in fact it was ready to do so with no persuasion at all. Bedford's big moment had come during the Convention, and after returning to Delaware he passed the remainder of his life in relative obscurity.

In 1789 President Washington appointed him Judge of the Federal District Court, and he held this post until his death 23 years later. While never again a figure of national stature, Bedford did enjoy the companionship of a large circle of prominent friends, many of whom he entertained at Lombardy Hall, his country home north of Wilmington. It was here that Bedford died in 1812.

**9. MAJOR BIBLIOGRAPHICAL REFERENCES**

Alden, Edmund K., "Gunning Bedford," Dictionary of American Biography, Vol. II, p. 123.

Beard, Charles A., An Economic Interpretation of the Constitution of the United States (New York, 1913).

Brandywine Hundred Chapter #174--The Questers, Inc., "Gunning Bedford, Jr., and His Home Lombardy Hall" (ms., n.d.).

(continued)

**10. GEOGRAPHICAL DATA**

LATITUDE AND LONGITUDE COORDINATES DEFINING A RECTANGLE LOCATING THE PROPERTY				O R	LATITUDE AND LONGITUDE COORDINATES DEFINING THE CENTER POINT OF A PROPERTY OF LESS THAN TEN ACRES				
CORNER	LATITUDE		LONGITUDE		LATITUDE		LONGITUDE		
	Degrees	Minutes	Seconds	Degrees	Minutes	Seconds	Degrees	Minutes	Seconds
NW	•	•	•	•	•	•	•	•	•
NE	•	•	•	•	•	•	•	•	•
SE	•	•	•	•	•	•	•	•	•
SW	•	•	•	•	•	•	•	•	•

APPROXIMATE ACREAGE OF NOMINATED PROPERTY: 1-1/2 ACRES.

LIST ALL STATES AND COUNTIES FOR PROPERTIES OVERLAPPING STATE OR COUNTY BOUNDARIES

STATE:	CODE	COUNTY:	CODE

**11. FORM PREPARED BY:**

NAME AND TITLE: Robert C. Post, Survey Historian

ORGANIZATION: Division of History, Office of Archeology and Historic Preservation, National Park Service DATE: 7/2/73

STREET AND NUMBER: 1100 L Street, N.W.

CITY OR TOWN: Washington STATE: D.C. CODE: \_\_\_\_\_

**12. STATE LIAISON OFFICER CERTIFICATION**      **NATIONAL REGISTER VERIFICATION**

As the designated State Liaison Officer for the National Historic Preservation Act of 1966 (Public Law 89-665), I hereby nominate this property for inclusion in the National Register and certify that it has been evaluated according to the criteria and procedures set forth by the National Park Service. The recommended level of significance of this nomination is:

National  State  Local

Name \_\_\_\_\_

Title \_\_\_\_\_

Date \_\_\_\_\_

I hereby certify that this property is included in the National Register.

\_\_\_\_\_  
Director, Office of Archeology and Historic Preservation

Date \_\_\_\_\_

ATTEST:

\_\_\_\_\_  
Keeper of The National Register

Date \_\_\_\_\_

SEE INSTRUCTIONS

( ) STATES DEPARTMENT OF THE INTERIOR ( )  
NATIONAL PARK SERVICE  
NATIONAL REGISTER OF HISTORIC PLACES  
INVENTORY - NOMINATION FORM

(Continuation Sheet)

STATE Delaware	
COUNTY New Castle	
FOR NPS USE ONLY	
ENTRY NUMBER	DATE

(Number all entries)

9. Bibliographical References (page 1) Lombardy Hall (Gunning Bedford House)

Conrad, Henry C., "Gunning Bedford, Jr., "Papers of the Historical Society of Delaware, Vol. XXVI (Wilmington, 1900).

Eberlein, H. D., and C. V. D. Hubbard, Historic Houses and Buildings of Delaware (Dover, 1963). 

Farrand, Max, The Records of the Federal Convention of 1787 (4 Vols., New Haven, 1911-1937).

Federal Writers' Project, Delaware: A Guide to the First State (New York, 1937).

Lombardy Hall Foundation, Lombardy Hall (pamphlet, n.p., n.d.).

Rossiter, Clinton, 1787: The Grand Convention (New York, 1966).

Listed in National Register of Historic Places, December 5, 1972; designated National Historic Landmark, December 2, 1974

Form 10-700  
(July 1967)

UNITED STATES DEPARTMENT OF THE INTERIOR  
NATIONAL PARK SERVICE

NATIONAL REGISTER OF HISTORIC PLACES  
INVENTORY - NOMINATION FORM

(Type all entries - complete applicable sections)

STATE Delaware	
COUNTY New Castle	
FOR NPS USE ONLY	
ENTRY NUMBER	DATE

1. NAME

Lombardy Hall

Pizogh (to 1785) New Wark (tract - to 1726)

2. LOCATION

STREET AND NUMBER:  
Route 202 (Concord Pike) North of Foulk Road (Route 261)

CITY OR TOWN:  
Wilmington

STATE: Delaware      CODE: 10      COUNTY: New Castle      CODE: 003

3. CLASSIFICATION

CATEGORY (Check One)	OWNERSHIP	STATUS	ACCESSIBLE TO THE PUBLIC
<input type="checkbox"/> District <input type="checkbox"/> Site <input type="checkbox"/> Object	<input checked="" type="checkbox"/> Building <input type="checkbox"/> Structure <input type="checkbox"/> Public <input checked="" type="checkbox"/> Private <input type="checkbox"/> Bath	<input type="checkbox"/> Occupied <input checked="" type="checkbox"/> Unoccupied <input checked="" type="checkbox"/> Preservation work in progress	<input checked="" type="checkbox"/> Yes <input type="checkbox"/> Restricted <input type="checkbox"/> Unrestricted <input type="checkbox"/> No
PRESENT USE (Check One or More as Appropriate)			
<input type="checkbox"/> Agricultural <input type="checkbox"/> Commercial <input type="checkbox"/> Educational <input checked="" type="checkbox"/> Entertainment	<input type="checkbox"/> Government <input type="checkbox"/> Industrial <input type="checkbox"/> Military <input type="checkbox"/> Museum	<input type="checkbox"/> Park <input type="checkbox"/> Private Residence <input type="checkbox"/> Religious <input type="checkbox"/> Scientific	<input type="checkbox"/> Transportation <input checked="" type="checkbox"/> Other (Specify): <u>Not in use at present</u> <input checked="" type="checkbox"/> Comments <u>Future use, museum and meeting hall.</u>

4. OWNER OF PROPERTY

OWNER'S NAME:  
Granite Lodge No. 34, A.F. & A.M., T. Leslie Williams, Sec'y.

STREET AND NUMBER:  
P. O. Box 7036

CITY OR TOWN: Wilmington      STATE: Delaware      CODE: 10

5. LOCATION OF LEGAL DESCRIPTION

COURTHOUSE, REGISTRY OF DEEDS, ETC.:  
Office of Recorder of Deeds, New Castle County Building

STREET AND NUMBER:  
Eleventh and King Street

CITY OR TOWN: Wilmington      STATE: Delaware      CODE: 10

6. REPRESENTATION IN EXISTING SURVEYS

TITLE OF SURVEY:  
Historical Buildings and Areas, New Castle County, Delaware

DATE OF SURVEY: June 30, 1967       Federal       State       County       Local

DEPOSITORY FOR SURVEY RECORDS:  
County Engineering Building

STREET AND NUMBER:  
Robert Kirkwood Highway

CITY OR TOWN: Wilmington      STATE: Delaware      CODE: 10

SEE INSTRUCTIONS

STATE  
COUNTY  
ENTRY NUMBER  
DATE

FOR NPS USE ONLY

## 7. DESCRIPTION

CONDITION	(Check One)					
	<input type="checkbox"/> Excellent	<input type="checkbox"/> Good	<input checked="" type="checkbox"/> Fair	<input type="checkbox"/> Deteriorated	<input type="checkbox"/> Ruins	<input type="checkbox"/> Unreposed
	(Check One)			(Check One)		
	<input type="checkbox"/> Altered	<input checked="" type="checkbox"/> Unaltered	<input type="checkbox"/> Moved	<input checked="" type="checkbox"/> Original Site		

DESCRIBE THE PRESENT AND ORIGINAL (If known) PHYSICAL APPEARANCE

**PRESENT:** Situated on partly-wooded high ground, about one and one third acres, adjacent to and sharing the entrance to Lombardy Cemetery for which the house served most recently as office and caretaker's quarters. Lombardy Hall is undergoing reconstruction and restoration. It is a five-bay, two and a half story, native stone house; two rooms deep with a central hall. The dark Brandywine gabbro rock facade and fieldstone north wall are restored, and the roof has been repaired and wood shingled. Grounds have been filled and sodded, a screen of evergreens planted at the south line. Chimneys have been repaired with old brick, 7 new flues installed. Rear and south exterior walls and most of the interior await funds for completion. However, work proceeds with volunteer labor as donations to cover costs come in. Most of the features of the original section as Bedford acquired it in the late 18th Century, remain. He added a ballroom, two second floor bedrooms, and rebuilt the attic and roof. The effect today is as he knew the house—a symmetrically balanced mansion of simple dignity. The windows in the Bedford section are set in wide-angled, panelled recesses, and an entrance door to the ballroom towards the back of the south wall, repeats this treatment. A delicately carved Adam-style mantel, closeted and shelved at each end, remains in the ballroom in remarkably good condition. Corner fireplaces in the bedrooms above, meet at the south wall, back to back, at the partition. A large portico and a one and a half story stone wing with separate entrance were added to the house p.1820, but were removed about 70 years ago. The Robinson section appears not to have been altered significantly except in the attic and roof, and a much later bathroom at the front part of the wide 2nd floor hall. A large attached garage constructed from stone of a barn and a carriage house once standing to the rear, serves as valuable storage at the present. Eventually it will be removed, the mansion set up as a Masonic museum, and a wing added to the rear for headquarters of Granite Lodge No. 34. The work proceeds under the guidance and plans of the architectural firm of Pope, Kruse and McCune, Wilmington.

SEE INSTRUCTION

**ORIGINAL:** "Pizgah" (the George Robinson house) is almost entirely intact and alterations from the original would have been quite early. A lintel of an old doorway remains behind a panelled wall cupboard in the rear room of the first floor, suggesting the possibility the first structure was primitive, that the refinements of panelling were made around 1750. All original windows are recessed at right angles. This section consisted of four rooms, two on each floor, with the hall and main entrances on the south side. The south exterior corners are visible in the straight line of the mortar running vertically at the facade and the rear wall. Modern windows have been removed from the north wall, and it is now windowless as first laid. Research by the Delaware Archaeological Society and interviews with past residents have established lines of long dismantled outbuildings, wells, and alterations to the main house.



**3. SIGNIFICANCE**

PERIOD (Check One or more appropriate)

<input type="checkbox"/> Pre-Columbian:	<input type="checkbox"/> 16th Century	<input checked="" type="checkbox"/> 18th Century	<input type="checkbox"/> 20th Century
<input type="checkbox"/> 15th Century	<input checked="" type="checkbox"/> 17th Century	<input type="checkbox"/> 19th Century	

SPECIFIC DATE(S) (If Applicable and Known) 12/20/1682; 1783-1785; 6/6/1806; 1/30/1812

AREAS OF SIGNIFICANCE (Check One or More as Appropriate)

<input type="checkbox"/> Aboriginal	<input checked="" type="checkbox"/> Education	<input checked="" type="checkbox"/> Political	<input type="checkbox"/> Urban Planning
<input type="checkbox"/> Prehistoric	<input type="checkbox"/> Engineering	<input checked="" type="checkbox"/> Religion/Philosophy	<input checked="" type="checkbox"/> Other (Specify)
<input type="checkbox"/> Historic	<input type="checkbox"/> Industry	<input type="checkbox"/> Science	<u>Fraternal</u>
<input checked="" type="checkbox"/> Agriculture	<input type="checkbox"/> Invention	<input type="checkbox"/> Sculpture	<u>Judicial</u>
<input checked="" type="checkbox"/> Architecture	<input type="checkbox"/> Landscape Architecture	<input type="checkbox"/> Social/Humanitarianism	<u>Legal</u>
<input type="checkbox"/> Art	<input type="checkbox"/> Literature	<input type="checkbox"/> Theater	
<input type="checkbox"/> Commerce	<input type="checkbox"/> Military	<input type="checkbox"/> Transportation	
<input type="checkbox"/> Communications	<input type="checkbox"/> Music		
<input type="checkbox"/> Conservation			

STATEMENT OF SIGNIFICANCE

Lombardy Hall is on William Penn's "Manor of Rocklands," 986 acres which he granted to Valentine Hollingsworth in 1682, and which Hollingsworth renamed "New Wark." He was founder of the Newark Monthly Meeting, Society of Friends, and his home where first meetings took place still stands, privately owned, at Marsh Road and Baynard Blvd. The Newark Union burial grounds remain with historic marker nearby. George Robinson, Hollingsworth's son-in-law, purchased from the tract 250 acres along Concord Road in 1726, and he named it "Pisgah." Through family inheritance it came into the possession of Charles Robinson, great grandson of Hollingsworth. In 1785 (deed recorded in 1793) Gunning Bedford, Jr., purchased the 250 acres and the small stone house from Charles Robinson. He expanded the house and made extensive improvements of the farm. He kept his house and office in town at 606 Market St., Wilmington. This was during the years of his greatest accomplishments, and it is recorded that the entertainment and hospitality at Lombardy for distinguished guests, often from abroad, were in the finest tradition. Mrs. Bedford, the former Jane Ballaroux Parker and daughter of James Parker, the editor of the Post Boy in New York, was greatly admired as a talented and charming hostess. They gave the estate the name it goes by today.

Gunning Bedford, Jr., signer of the Constitution, served also as delegate from Delaware to the Continental Congress, 1783-1785. He was appointed state attorney-general in 1784, and in 1786 was one of the delegates sent from Delaware to the Annapolis Convention. It was as a delegate to the Constitutional Convention called the following year that Bedford led the successful fight for equal state representation in the United States Senate. He held from Pres. Washington the commission of first Judge of the District Court of the U.S. for Delaware until his death March 30, 1812. His father, also Gunning Bedford, was an architect and had an important role in the designing and founding of Carpenters' Hall in Philadelphia. He made his home with his son in later life, undoubtedly assisting in the supervision of the remodeling of Lombardy. He died there in 1802.

Bedford developed his 250 acres as a model farm. Throughout his career he was involved with education; was president of the

SEE INSTRUCTIONS

UNITED STATES DEPARTMENT OF THE INTERIOR  
NATIONAL PARK SERVICE  
NATIONAL REGISTER OF HISTORIC PLACES  
INVENTORY - NOMINATION FORM

STATE Delaware	
COUNTY New Castle	
FOR NPS USE ONLY	
ENTRY NUMBER	DATE

(Continuation Sheet)

(Number all entries)

8. SIGNIFICANCE. (continued)

board of trustees of the Wilmington Academy . He was also an active abolitionist. His portrait by Charles Willson Peale, hangs in the Capitol in Washington. He is not to be confused with a first cousin, Gunning Bedford, "Sr." of New Castle, who was governor of Delaware and a brother-in-law of George Read, signer of the Declaration of Independence.

Bedford was elected June 6, 1806, First Grand Master of the Grand Lodge of Delaware, A.F. & A.M., and his historic association with the Masons led to the interest of Granite Lodge No. 34 in the purchase and restoration of Lombardy. The lodge acquired the threatened property in 1967.

Gunning Bedford, Jr. was a graduate of Princeton, where he was a classmate of James Madison.

**9. MAJOR BIBLIOGRAPHICAL REFERENCES**

Delaware Historical Society of Delaware: 14 Vol. 1946-1971, published semiannually, Wilmington, Delaware.  
 Green, Charles E., History of the Grand Lodge: 1956, Wilmington.  
 Conrad, Henry C., Gunning Bedford, Junior: Papers of the Historical Society of Delaware, XXVI. 1900, Wilmington.  
 Cooch, Edward W., Delaware Historic Events: 1946, E.W. Cooch, Cooch's Bridge, Delaware, Copyright.  
 Bartlett, Edward P., Friends in Wilmington 1738-1938: Wilmington, 1938.  
 Read, William T., Life and Corres. of George Read: Phila., 1870

**10. GEOGRAPHICAL DATA**

LATITUDE AND LONGITUDE COORDINATES DEFINING A RECTANGLE LOCATING THE PROPERTY			LATITUDE AND LONGITUDE COORDINATES DEFINING THE CENTER POINT OF A PROPERTY OF LESS THAN TEN ACRES		
CORNER	LATITUDE	LONGITUDE	LATITUDE		LONGITUDE
	Degrees Minutes Seconds	Degrees Minutes Seconds	Degrees	Minutes Seconds	Degrees Minutes Seconds
NW	.	.	39	46 53	75 32 41
NE	.	.			
SE	.	.			
SW	.	.			

APPROXIMATE ACREAGE OF NOMINATED PROPERTY: **1 1/3**

LIST ALL STATES AND COUNTIES FOR PROPERTIES OVERLAPPING STATE OR COUNTY BOUNDARIES

STATE:	CODE	COUNTY:	CODE

**11. FORM PREPARED BY**

NAME AND TITLE: Mr. and Mrs. Earl D. Krapp

ORGANIZATION: \_\_\_\_\_ DATE: \_\_\_\_\_

STREET AND NUMBER: 603 Northside Drive

CITY OR TOWN: Wilmington STATE: Delaware 19809 CODE: 10

**12. STATE LIAISON OFFICER CERTIFICATION**

As the designated State Liaison Officer for the National Historic Preservation Act of 1966 (Public Law 89-665), I hereby nominate this property for inclusion in the National Register and certify that it has been evaluated according to the criteria and procedures set forth by the National Park Service. The recommended level of significance of this nomination is:

National  State  Local

Name: Dr. E. Berkeley Tompkins  
 Title: State Liaison Officer

Date: \_\_\_\_\_

**NATIONAL REGISTER VERIFICATION**

I hereby certify that this property is included in the National Register.

Chief, Office of Archeology and Historic Preservation

Date: \_\_\_\_\_

ATTEST:  
 \_\_\_\_\_  
 Keeper of The National Register

Date: \_\_\_\_\_

SEE INSTRUCTIONS

UNITED STATES DEPARTMENT OF THE INTERIOR  
NATIONAL PARK SERVICE  
NATIONAL REGISTER OF HISTORIC PLACES  
INVENTORY - NOMINATION FORM

(Continuation Sheet)

STATE Delaware	
COUNTY New Castle	
FOR NPS USE ONLY	
ENTRY NUMBER	DATE

(Number all entries)

9. MAJOR BIBLIOGRAPHICAL REFERENCES.

Lombardy of The Bedford Clan, The Delmarva Star, Wilmington, Delaware, November 19, 1933. Article filed at Historical Society of Delaware.

Eberlein, H.D. and Hubbard, C.V.D., Historic Houses and Buildings of Delaware: Public Archives Commission, Dover, Delaware, 1963.

Project and Historic Research Reports on Lombardy and Gunning Bedford, Jr., presented to Granite Lodge No. 34.

A. Brandywine Hundred Chapter #174, The Questers, Inc. Scrap book, 1967.

B. The Crest Century Club, Scrap book, 1968.